

INSTALLATION GUIDE
2016- CURRENT UTILITY
PUSH BUMPER WRAPS
4PBFW47UINT16

Pro-gard[™]
PRODUCTS LLC.

STRONG | RELIABLE | SECURE

THESE COMPONENTS ARE REQUIRED
TO INSTALL THE PUSH BUMPER WRAPS

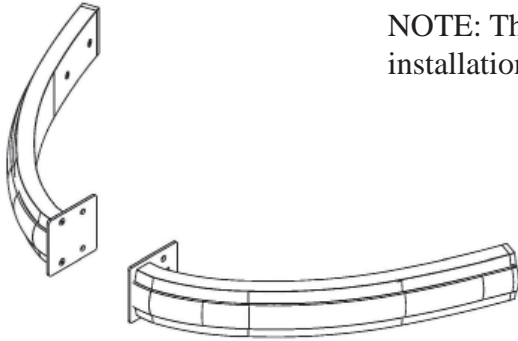

Push Bumper Wrap System
Part # 3PBW4716-00

NOTE: The Pro-gard HD Push Bumper is required for the installation of the push bumper wraps.



Part # 4PBFW4716-KIT

I. The following tools will be required to complete the installation.

- | | | |
|-------------------------|------------------|--------------------|
| A. 7/16 Socket | D. 3/4 Socket | G. 1/2 Socket |
| B. 18mm Socket | E. T-15 Torx Bit | H. 5/16 Drill Bit |
| C. Phillips Screwdriver | F. T-50 Torx Bit | I. 1-1/2" Hole Saw |

II. Read all instructions carefully and refer to the last page BOM to ensure all parts were received. *The push bumper wraps should be installed after the push bumper. Refer to the push bumper kit for instructions.*

III. Remove Push Bumper and Fascia

- A. Remove the push bumper and brackets necessary to remove fascia.
- B. Remove the vehicle's front fascia to expose the sub-frame.

IV. Install Wrap Support Brackets

- A. Attach the lower bracket 3PBW4716-02PS to the sub-frame using the 3X148 bolt, 3X13 washer and 3X195 nut. (Fig 1 & 2)

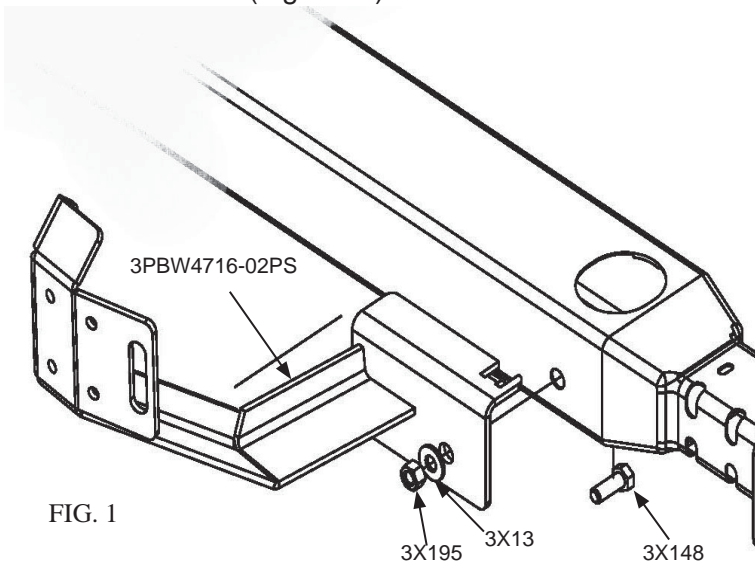

FIG. 1

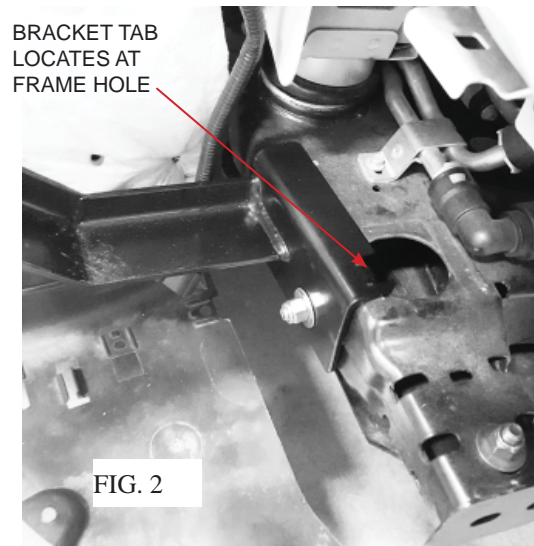
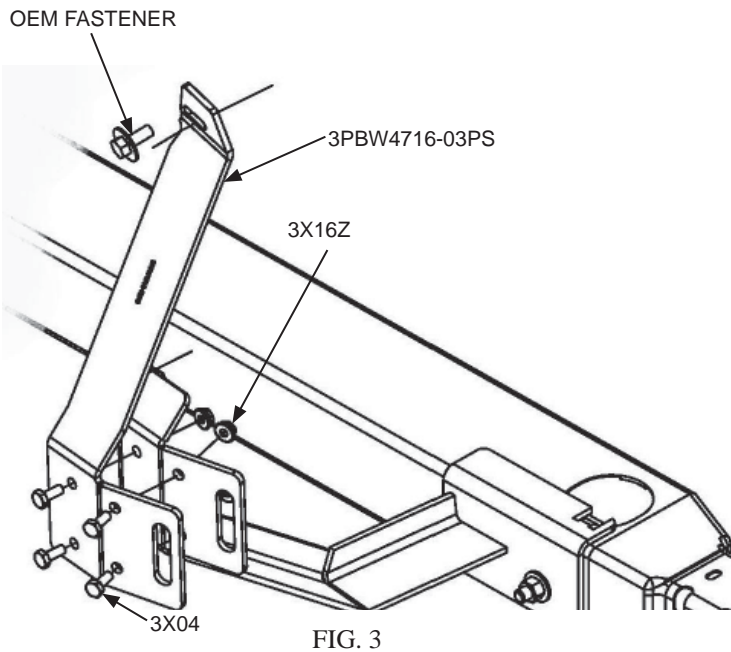

FIG. 2

B. Attach the upper bracket 3PBW4716-03PS using an OEM hole location and bolt and the (4) 3X04 bolts and 3X16Z nuts. (Fig 3 & 4) Tighten all the the hardware after adjusting for proper fit making sure the slots in the brackets align. Repeat on the driver side.



V. Modify Fascia

- Use the templates in the rear of the instructions, mark and cut a relief in the air ducting inside the fascia on each end.
- Using the second pair of templates at the rear of the instructions, mark and drill through the outside of the fascia on both ends using a hole saw.
- Reinstall the fascia leaving the fender liners loose to allow access for outer bracket assembly. Re-mount the Push Bumper.

VI. Assemble Outer Bracketry

- Align the 3PBW4716-04 standoff with the slot on the installed upper & lower brackets and through the hole in the fascia (Fig 6). Align the 3PBW1200 hat channel bracket and fasten the parts together using the provided 3X244 bolt, 3X508 washers and 3X165 nut (Fig. 5). Repeat for the drivers side.

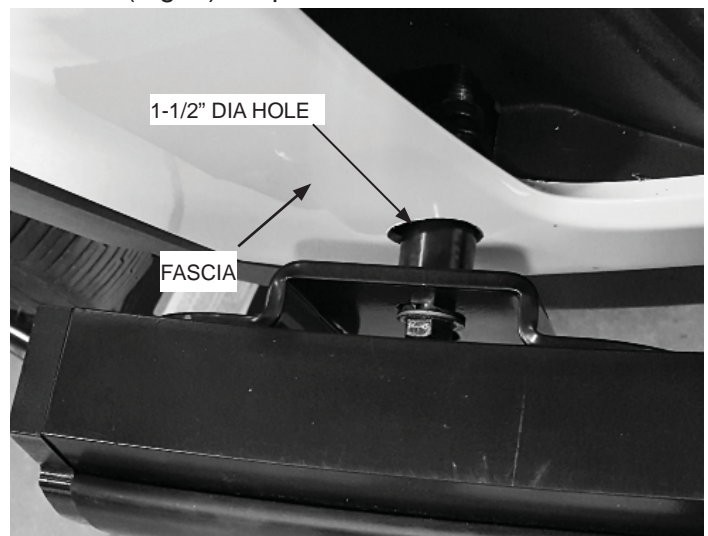
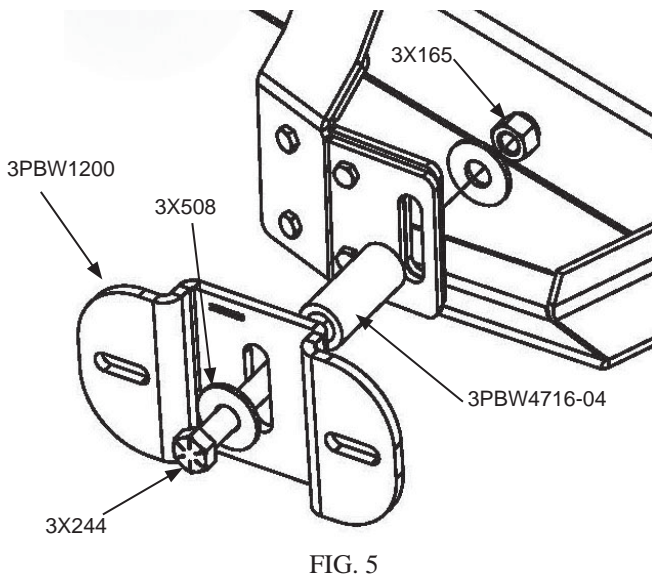

VII. Install Wrap Assemblies

- A. Support the push bumper. Disassemble the mounting bolts and keep the lock washers and nuts for re-use.
- B. Align the PBW4716-00 wrap and the PBW1302 backer plate and fasten the parts together using the provided 3X212 bolts, and re-using the nuts and washers. (Fig. 7) . It may be necessary to have someone assist you with aligning the parts.
- C. Repeat for opposite side.

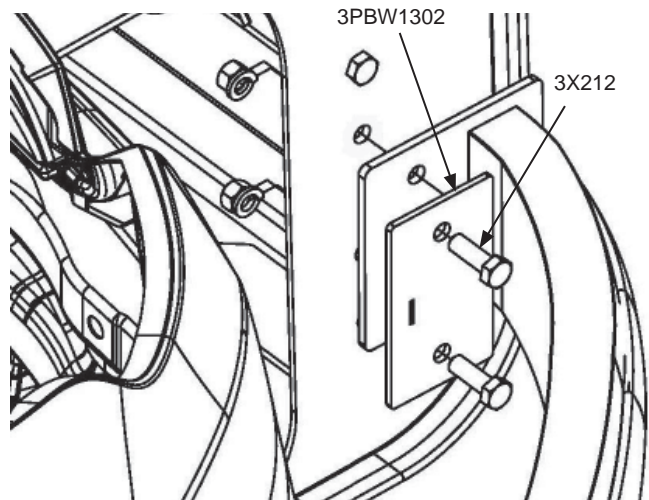

FIG. 7

VIII. Fasten Wrap to Outer Bracket

- A. Orient the 3PBW1200 Hat Channel Brackets as shown in Figure 8, in order to line up the two slots with the rivet nuts in the push bumper wraps.
- B. Fasten the brackets to the push bumper wraps using the provided 3X119 bolts and the 3X13 washers.
- C. Adjust the overall installation for fit and function of all components. Once satisfied, insure all fasteners are tight.

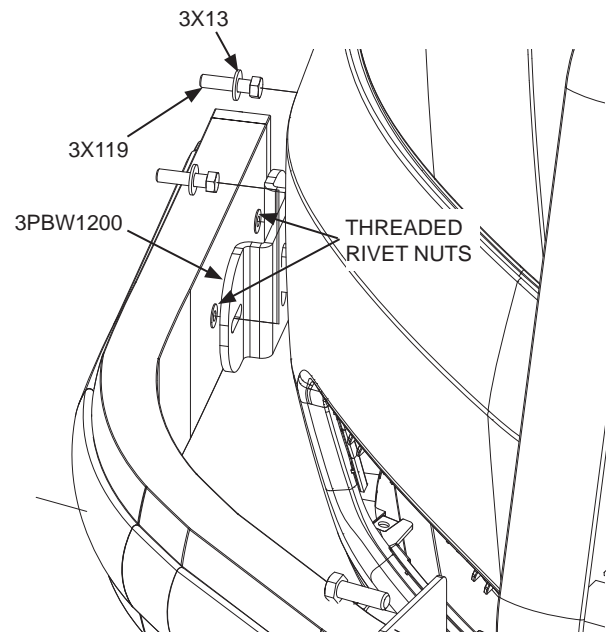
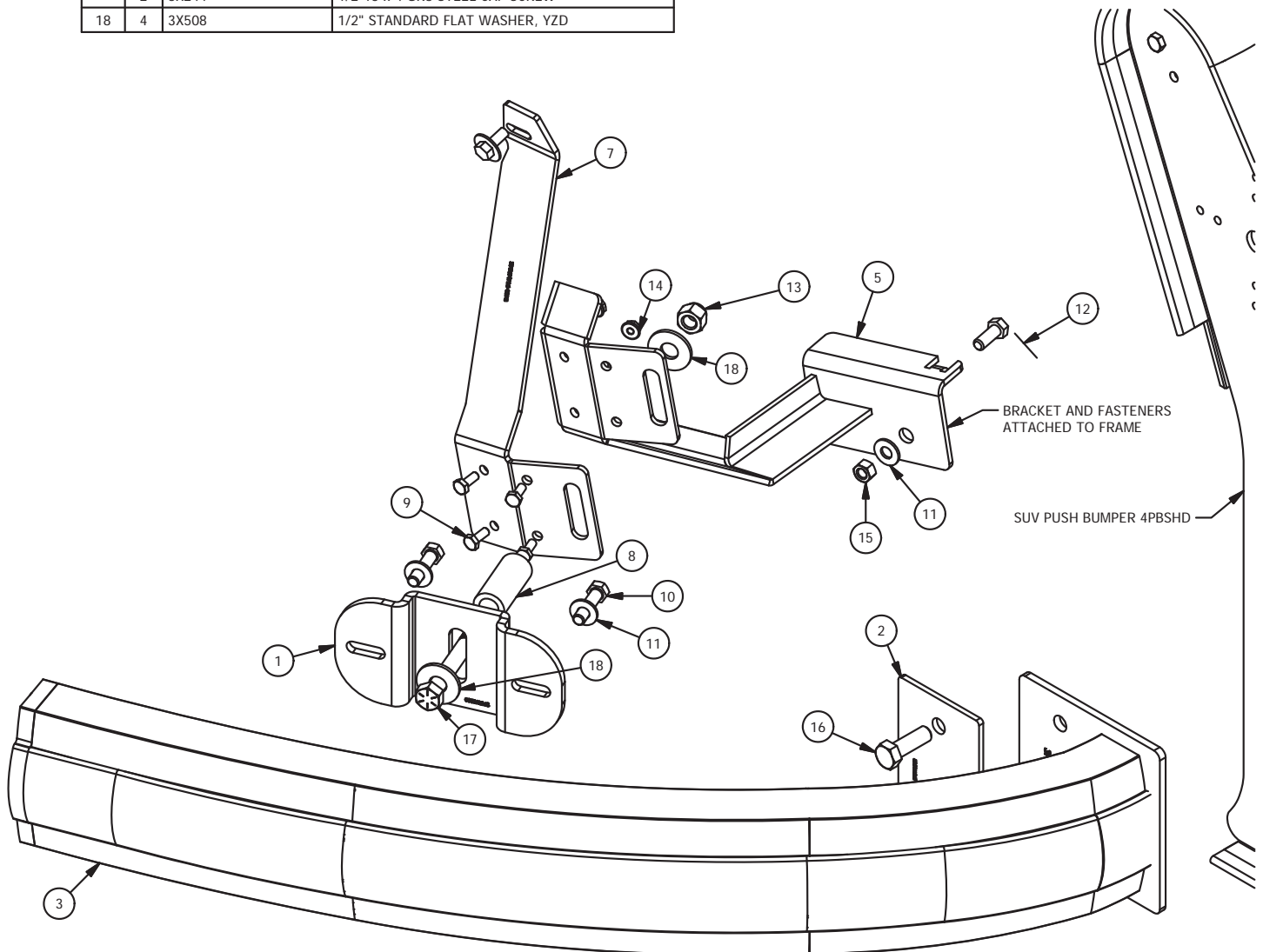

FIG. 8

Installation complete!

If you have any problems with this installation then call the toll free number (800-480-6680) and ask for technical assistance.

| PARTS LIST | | | |
|------------|-----|---------------|-----------------------------------|
| ITEM | QTY | PART NUMBER | DESCRIPTION |
| 1 | 2 | 3PBW1200 | PB WRAP BEAM HAT BRKT |
| 2 | 2 | 3PBW1302 | PB WRAP BACKER PLATE UINT 16 |
| 3 | 2 | 3PBW4716-00 | PB WRAP ASSEMBLY UINT 16 |
| 4 | 1 | 3PBW4716-02DS | PB WRAP LOWER BRKT UINT 16 |
| 5 | 1 | 3PBW4716-02PS | PB WRAP LOWER BRKT UINT 16 |
| 6 | 1 | 3PBW4716-03DS | PB WRAP UPPER BRKT UINT 16 |
| 7 | 1 | 3PBW4716-03PS | PB WRAP UPPER BRKT UINT 16 |
| 8 | 2 | 3PBW4716-04 | PB WRAP STANDOFF 2-1/4" UINT 16 |
| 9 | 8 | 3X04 | 1/4-20 X 5/8 HEX HD CAP SCR, BLK |
| 10 | 4 | 3X119 | 3/8-16 X 1-1/2, YZ, GR8, FL THD |
| 11 | 6 | 3X13 | 3/8 FLAT WSHR, YZ |
| 12 | 2 | 3X131 | 3/8-16 x 1.00" HEX HD YELLOW ZINC |
| 13 | 2 | 3X165 | 1/2-13, NYLON LOCK NUT, YZD |
| 14 | 8 | 3X16Z | 1/4-20 WHIZ NUT |
| 15 | 2 | 3X195 | 3/8-16 Nut, GR8, Blk Zn/C |
| 16 | 4 | 3X212 | 1/2-13X1 1/2 HEX CAP GR 8 BLK |
| 17 | 2 | 3X244 | 1/2-13 x 4 GR8 STEEL CAP SCREW |
| 18 | 4 | 3X508 | 1/2" STANDARD FLAT WASHER, YZD |



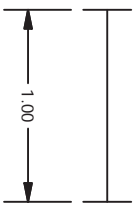
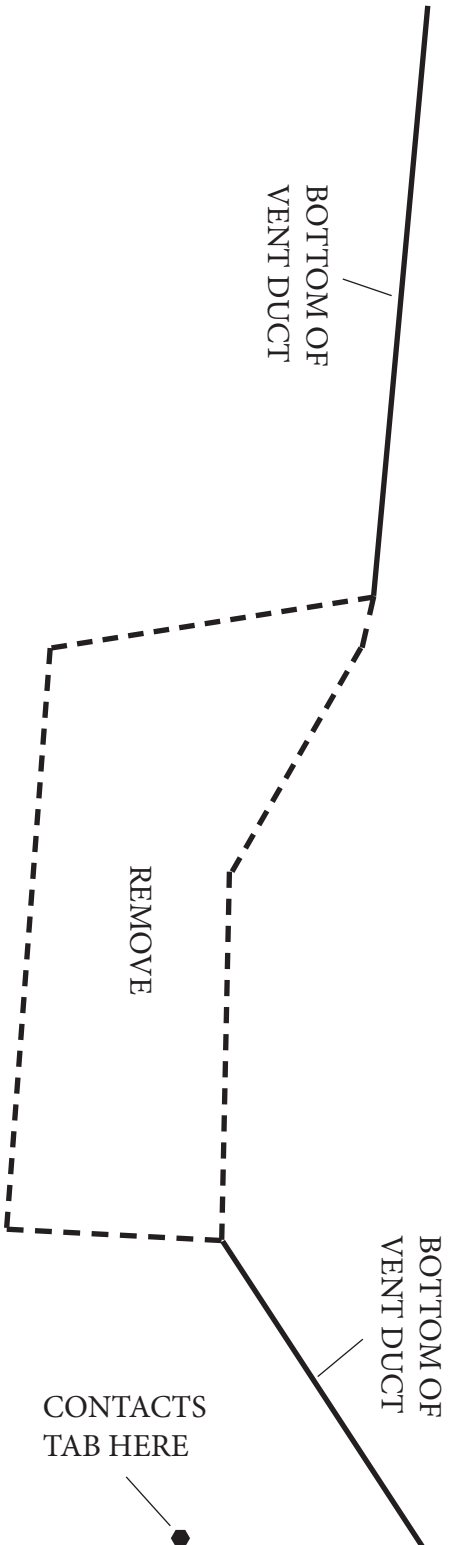

CHECK SCALE

PRINT TEMPLATE AT
ACTUAL SIZE

UTILITY PUSH BUMPER WRAPS
DRIVER SIDE TEMPLATE

UTILITY PUSH BUMPER WRAPS PASSENGER SIDE TEMPLATE

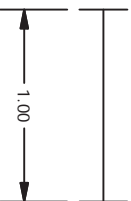

CHECK SCALE

PRINT TEMPLATE AT
ACTUAL SIZE

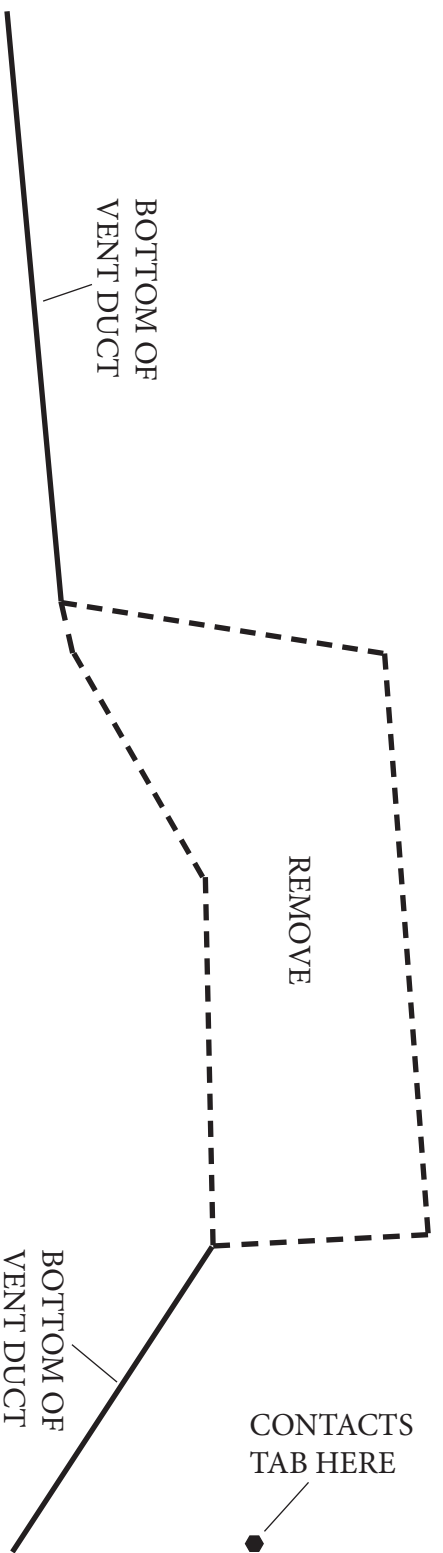

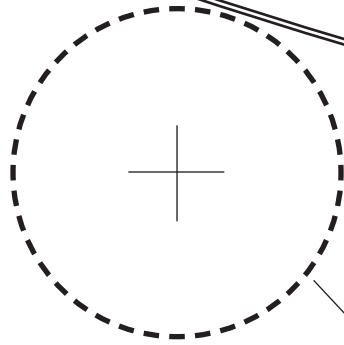

CUT A 1-3/4" HOLE ALONG
THE DASHED LINE

LINE UP THE TEMPLATE WITH THE
CORRESPONDING EDGES OF THE
FASCIA

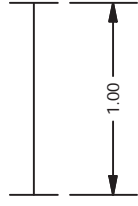

CHECK SCALE

PRINT TEMPLATE AT
ACTUAL SIZE

UTILITY PUSH BUMPER WRAPS
DRIVER SIDE HOLE TEMPLATE

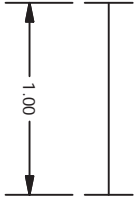

CHECK SCALE

PRINT TEMPLATE AT
ACTUAL SIZE

LINE UP THE TEMPLATE WITH THE
CORRESPONDING EDGES OF THE
FASCIA

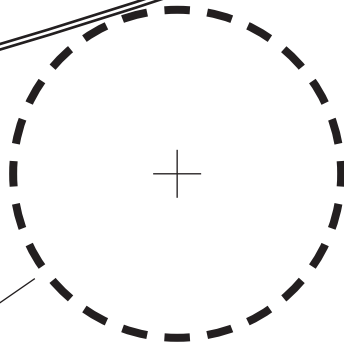

CUT A 1-3/4" HOLE ALONG
THE DASHED LINE

UTILITY PUSH BUMPER WRAPS
PASSENGER SIDE HOLE TEMPLATE