

INSTALLATION GUIDE

**2020 - CURRENT
FORD POLICE INTERCEPTOR UTILITY
TRANSPORT SEAT AND OSB SYSTEM
S4702UINT20
S4705UINT20
S4702UINT20OSB
S4705UINT20OSB**

Pro-gardTM
PRODUCTS LLC.

STRONG. RELIABLE. SECURE.

**THESE COMPONENTS ARE REQUIRED
TO INSTALL THE TRANSPORT SEAT**

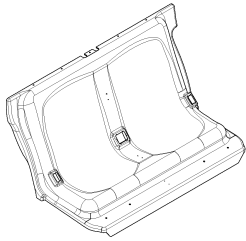

3TRS472000

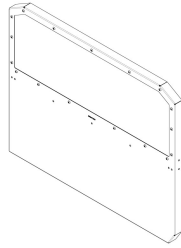

4BAR472001

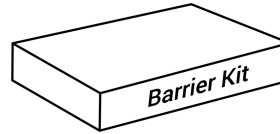

4BAK472000



4WIK472001

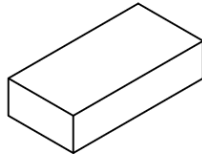

4TRK472000

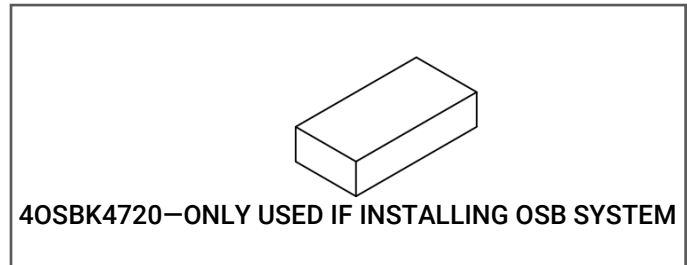

4OSBK4720—ONLY USED IF INSTALLING OSB SYSTEM

I. The following tools will be required to complete the installation

- | | | |
|-----------------------|-----------------------|--------------------|
| A. Trim removal tools | D. 7/16" socket | G. T25 Torx driver |
| B. 13mm socket | E. 3/16" Allen wrench | H. Socket wrench |
| C. 5/8" socket | F. 7/32" Allen wrench | I. 9/32" drill bit |

II. Read all instructions and refer to the Parts List to ensure all parts were received.

WARNING: *Locate all wiring, fuel lines, brake lines, coolant lines, and refrigerant lines before drilling any holes or installing any self-drilling fasteners.*

III. OEM Seat Removal

- A. Remove all the bolts holding down the second row seats.
- B. Unclip the electrical connectors under each seat.
- C. Remove the seats from the vehicle.
- D. Remove the rear sill and the rear step trims.
- E. Remove factory seat belt buckles from driver, passenger, and center seats including the wiring harness. Note which buckle is in each location as these will later have to be plugged back into the correct harness. These buckles will be needed regardless of whether reusing the factory buckles or using the Pro-gard OSB buckle system.

IV. Preparation

- A. If installing the OSB belts remove the interior rear quarter trim to gain access to the factory retractable seat belts.
- B. Remove the bolt retaining the lower belt anchor and restrain the belt from movement behind the trim.
- C. Reinstall the quarter trim.
- D. Install the barrier and barrier kit per barrier instructions.

V. Floor Pan Installation

- A. If not installing a floor pan, proceed to Section VI. If also not installing the OSB system, reinstall the rear step and sill trims.
- B. Set the floor pan into the vehicle with the large vertical flange towards the rear of the vehicle.
- C. The floor pan sits underneath the OEM trim panels. The lower B-pillar trim panels can be placed either inboard or outboard of the floor pan flange. If not installing the OSB system, the rear step and sill trims can be reinstalled at this point.

VI. Seat Top Tube Installation

- A. Remove the (4) button head screws [3X611] on the front face of the barrier holding the rear brackets on.
- B. Orient the Seat Top Tube [3OSB472000] such that the 5 small holes face up, this is the face that the seat will screw into later on.
- C. Attach the Seat Top Tube [3OSB472000] to the barrier using the (4) button head screws [3X611] removed in the previous step and (3) additional button head screws [3X611] and (3) whiz nuts [3X166]. Tighten all screws.

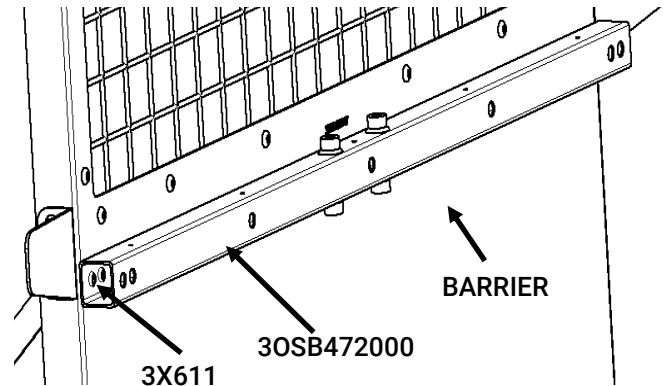

VII. Lower Bracket Installation

- A. Install the Center Buckle Bracket [3OSB472001] by removing the center rear factory bolts holding the seat subframe down and installing it in that location with the angled lip facing forward.
- B. Reinstall the factory subframe bolts.
- C. Align the (2) Front Seat Support Brackets [3OSB472005] over the holes from the driver and passenger seat bolts. Install and tighten the (4) OEM seat bolts.
- D. Plug the electrical harness for the driver, center, and passenger buckles back into their respective connectors on the vehicle. All OEM buckles must be plugged into the vehicle to prevent any warning lights and ensure proper restraint operation.
- E. If installing a P1000UINT20AOSB, follow the OSB belt instructions for the passenger side and the OEM belt instructions for the driver side.

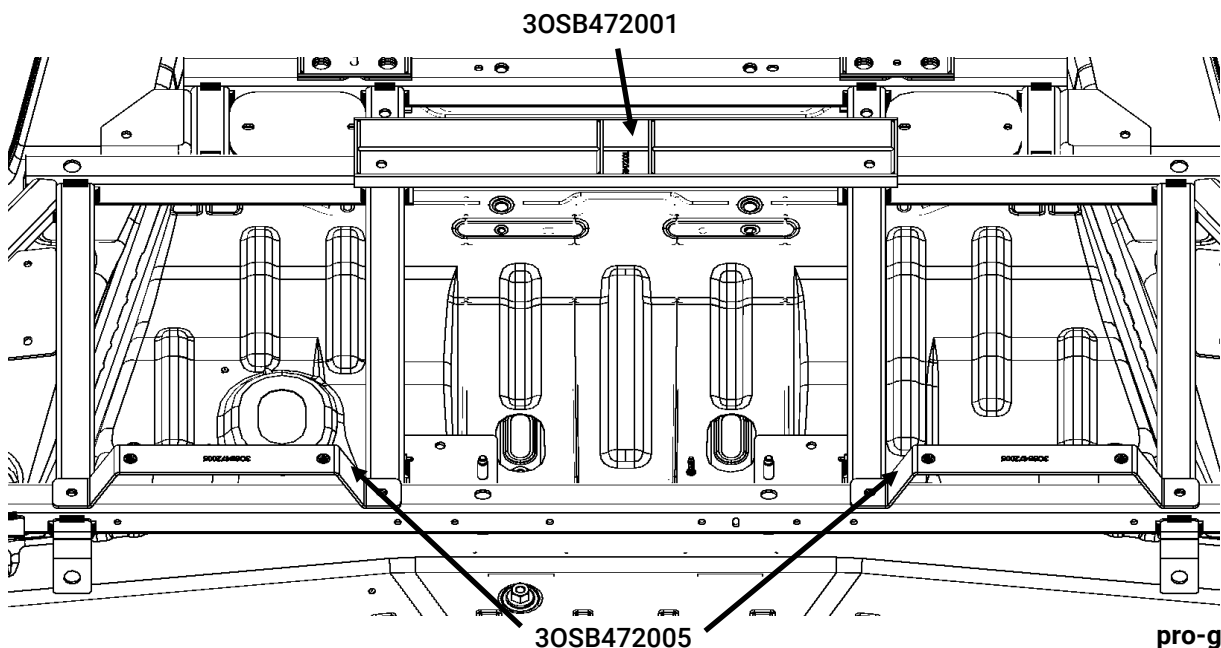

VIII.OSB Bracket Installation (if using the OSB system)

- A. Remove the rear outer seat sub-frame bolts on the driver and passenger side.
- B. Place the Passenger OSB Bracket [3OSB472014] by aligning the hole over the outer seat sub-frame bolt hole with the tab engaged on the back side of the OEM tube. The vertical flange should be towards the center line of the vehicle. Install the rear sub-frame bolt back into its respective location.
- C. Repeat the process on the driver side for the Driver OSB Bracket [3OSB472015].
- D. All the factory seat bolts and seat sub-frame bolts should now be re-installed and tightened to factory torque specifications.

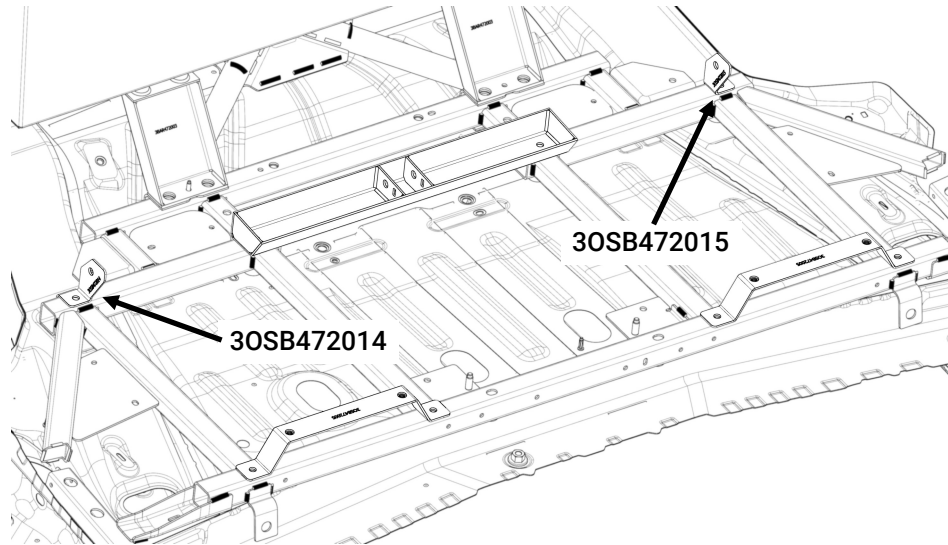

IX. Belt Installation using factory belts

- A. The center buckle, if so equipped, can be zip tied or restrained from movement in some manner to the subframe so that it does not move around.
- B. The driver side buckle can now be attached to the Center Buckle Bracket [3OSB472001] by inserting the factory buckle anchor's formed tab through the slot in the driver's side mounting face at the center of the Center Buckle Pan and inserting the factory bolt through the anchor and the mounting face and tightening down with the M10 nut [3X617].
- C. Repeat the process above for the passenger side buckle.

X. Belt Installation using Pro-gard OSB belts

- A. Attach a Lower Release Buckle with Stake [3OSB109RP] to the outer face of the Passenger OSB Bracket [3OSB472014], aligning the edge of the stake with the angled edge of the bracket. Insert a 7/16-20 bolt [3X616] through the Lower Release Buckle with Stake [3OSB109RP] and Passenger OSB Bracket [3OSB472014] and affix with a 7/16-20 nut [3X614]. Tighten nut and keep edge of stake and bracket aligned.
- B. Repeat this process for the Driver OSB Bracket [3OSB472015].
- C. Attach the anchor closest to the buckle tab end of the belt [3OSB001] to the Center Buckle Pan [3OSB472001] with the anchor tab on the outward facing mounting face, using 7/16-20 bolt [3X616] and 7/16-20 nut [3X614] and tighten down. Perform this for both the OSB belts.

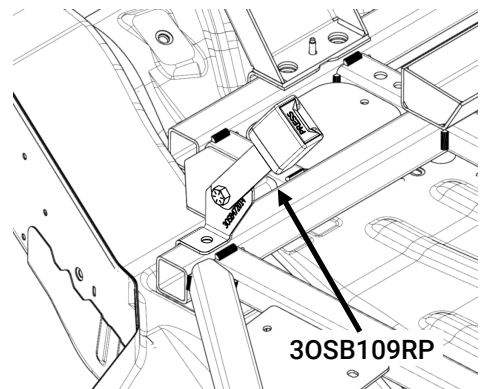

Note: OEM bolts not shown

- D. Place the Transport Seat [3TRS472000] in the vehicle and feed OSB Belts [3OSB001] through the center opening.
- E. Attach the other anchor end of the OSB Belt [3OSB001] to the threaded inserts in the Seat Top Tube [3OSB472000] using (2) 7/16-20 bolts [3X616]. Ensure that the passenger side belts are all attached to the passenger side mounting points and the driver side belts are all attached to the driver side mounting points.

XI. Seat Installation

- A. Place the Transport Seat [3TRS472000] such that the top flange rests on the Seat Top Tube [3OSB472000] and the bottom flange rests on the (2) Front Seat Brackets [3OSB472005].
- B. For an OSB installation the belts will already be inserted through the seat, for non-OSB systems pull the OEM buckles through the opening in the middle of the Transport Seat [3TRS472000].
- C. Attach the front of the seat to the Front Seat Brackets [3OSB472005] using (4) 3/8-16 button head screws [3X247] and (4) large flat washers [3X224].
- D. Attach the rear of the Transport Seat [3TRS472000] to the Seat Top Tube [3OSB472000] using (5) self-tapping screws [3X615] and (5) small flat washers [3X12]. The screws go into the pre-drilled holes, use caution not to over-tighten the screws and risk stress cracking the seat.

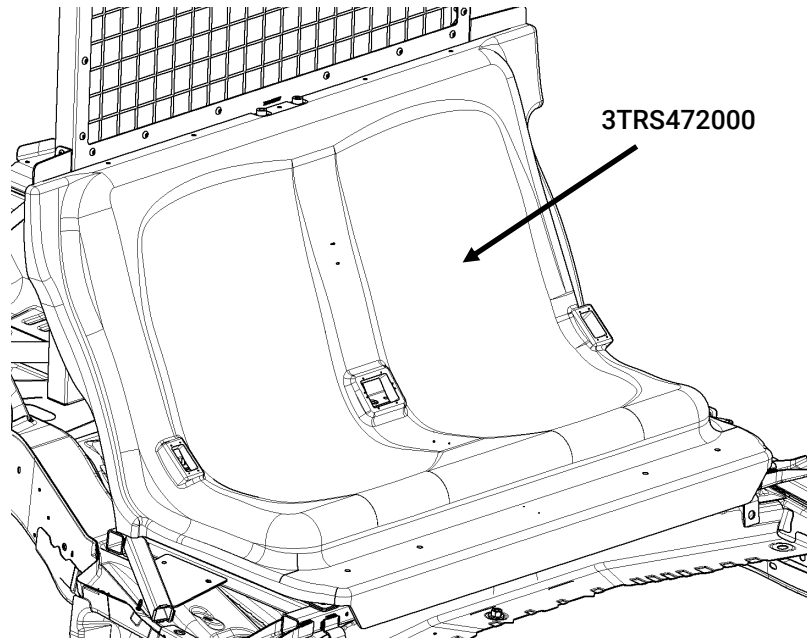

XII. Trim Panel Installation

- A. If using the OEM belts install the (2) Non-OSB Outer Pucks [3TRS472002] to the Transport Seat [3TRS472000] using (4) #8 screws [3X72] on each side.
- B. If using the OSB belt buckle install the (2) OSB Outer Pucks [3OSB472008] to the Transport Seat [3TRS472000] using (4) #8 screws [3X72] on each side.
- C. If using the OEM buckles install the Non-OSB Center Puck [3TRS472003] by threading the OEM buckle through the slots in the trim piece then screwing it down using (8) #8 screws [3X72].
- D. If using the OSB belts install the OSB Center Puck [3OSB472011] by threading the belt through the slots in the trim piece then screwing it down using (8) #8 screws [3X72].

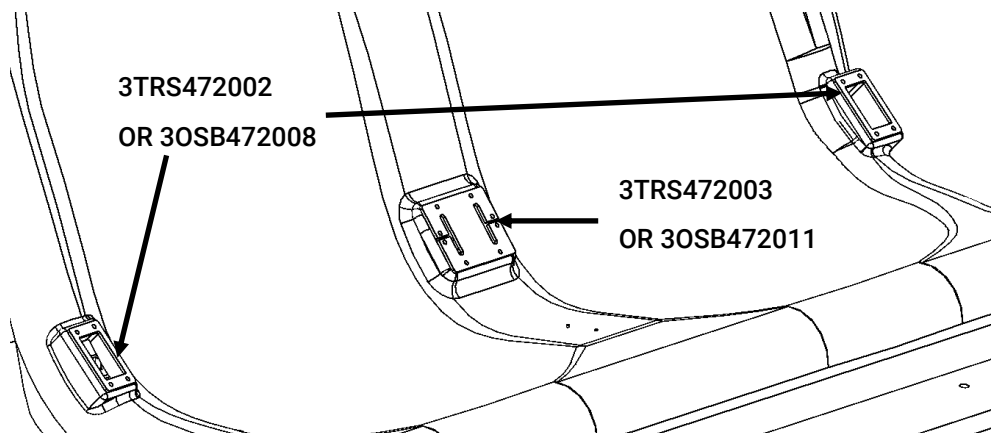

XIII.OSB Partition Buckle Installation

- A. Locate Partition Buckle [3OSB109RP-1] on the partition, ensuring the end of the buckle does not protrude past the partition into the prisoner area to avoid a catch point. The figure to the right shows the recommended position.
- B. Drill two 9/32" holes, one at each end of the buckle's slotted mounting tab, and attach with (2) carriage bolts [3X36] and (2) nuts [3X16Z]. This allows for the seat belt to be placed in the open position for receiving a passenger.



XIV.Finishing Steps

- A. Ensure that either the factory belts or the OSB belts operate properly.

Installation complete

If you have any problems with this installation or have any questions please call (800-480-6680) and ask for technical assistance.

ITEM	QTY	PART NUMBER	DESCRIPTION
1	1	BA705UINT20	2020 UTILITY BARBER ASSEMBLY WIRE
2	1	3058472001	OSB BAR WELDMENT
3	1	3058472001	OSB CENTER WELDMENT
4	1	37RS472000	2020 UTILITY TRANSPORT SEAT
5	2	3058472005	SEAT SUPPORT BRACKET WELDMENT
6	2	37RS472002	TRANSPORT SEAT TRIM PIECE
7	16	3X72	#8 X 5/8" PHILIPS TRUSS HD
8	1	37RS472003	CENTER SEATBELT TRIM PIECE
9	4	3X247	3/8" x 1 1/2" WASHER
10	4	3X224	3/8" x 1 1/2" WASHER
11	3	3X611	5/16-18 X 7/8" LONG BUTTON HEAD CAP SCREW
12	3	3X166	5/16-18 LARGE HEX WHIZ NUT-ZINC
13	2	3X617	M10X1.5 SERATED FLANGE NUT, GR 10

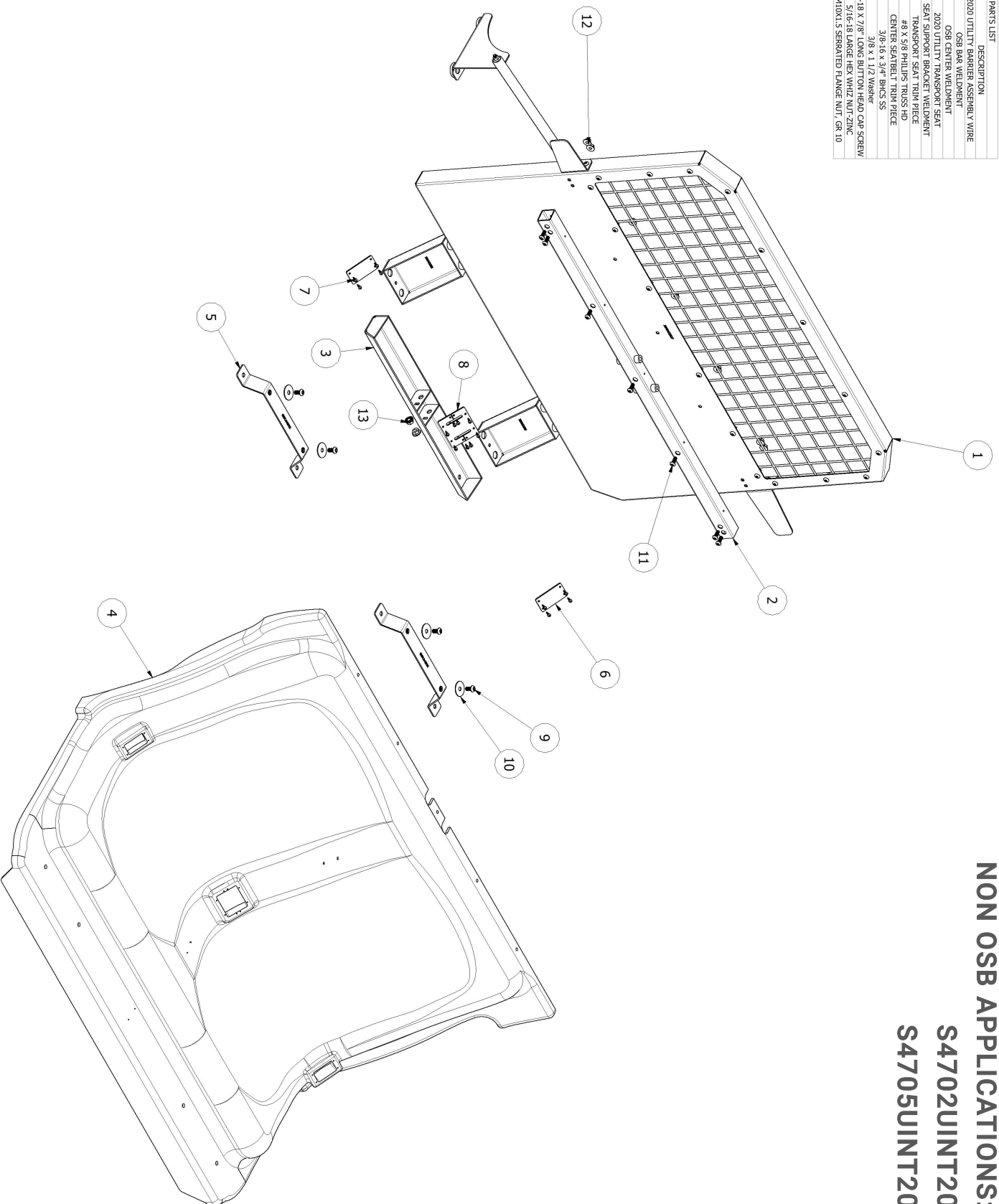

NON OSB APPLICATIONS:
S4702UINT20
S4705UINT20

pro-gard.com
800.480.6680

OSB APPLICATIONS: **S4702UUNIT200OSB** **S4705UUNIT200OSB**

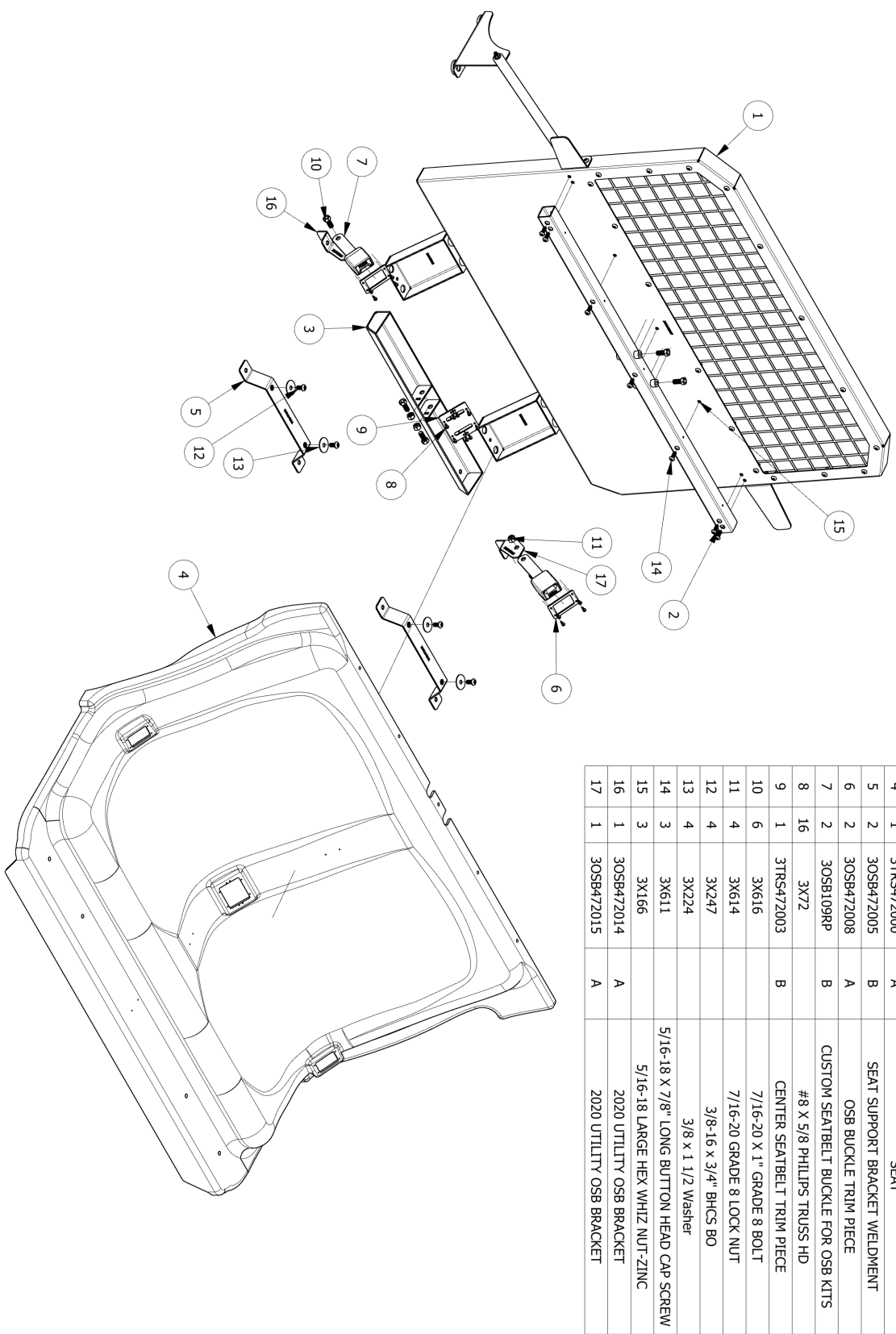

PARTS LIST				
ITEM	QTY	PART NUMBER	REVISION NUMBER	DESCRIPTION
1	1	B4705UUNIT20	B	2020 UTILITY BARRIER ASSEMBLY WIRE
2	1	30SB472000	A	OSB BAR WELDMENT
3	1	30SB472001	B	OSB CENTER WELDMENT
4	1	3TRSA72000	A	SEAT
5	2	30SB472005	B	SEAT SUPPORT BRACKET WELDMENT
6	2	30SB472008	A	OSB BUCKLE TRIM PIECE
7	2	30SB109RP	B	CUSTOM SEATBELT BUCKLE FOR OSB KITS
8	16	3X72		#8 X 5/8 PHILLIPS TRUSS HD
9	1	3TRSA72003	B	CENTER SEATBELT TRIM PIECE
10	6	3X616		7/16-20 X 1" GRADE 8 BOLT
11	4	3X614		7/16-20 GRADE 8 LOCK NUT
12	4	3X247		3/8-16 X 3/4" BHCS BO
13	4	3X224		3/8 X 1 1/2 WASHER
14	3	3X611		5/16-18 X 7/8" LONG BUTTON HEAD CAP SCREW
15	3	3X166		5/16-18 LARGE HEX WHIZ NUT-ZINC
16	1	30SB472014	A	2020 UTILITY OSB BRACKET
17	1	30SB472015	A	2020 UTILITY OSB BRACKET