

INSTALLATION GUIDE

**2015-2020 CHEVY TAHOE
P1000T15AOSB**

Pro-gard[™]
PRODUCTS LLC.

STRONG | RELIABLE | SECURE

RELEASED 10.19.2018

**pro-gard.com
800.480.6680**

THESE COMPONENTS ARE REQUIRED
TO INSTALL THE PARTITION

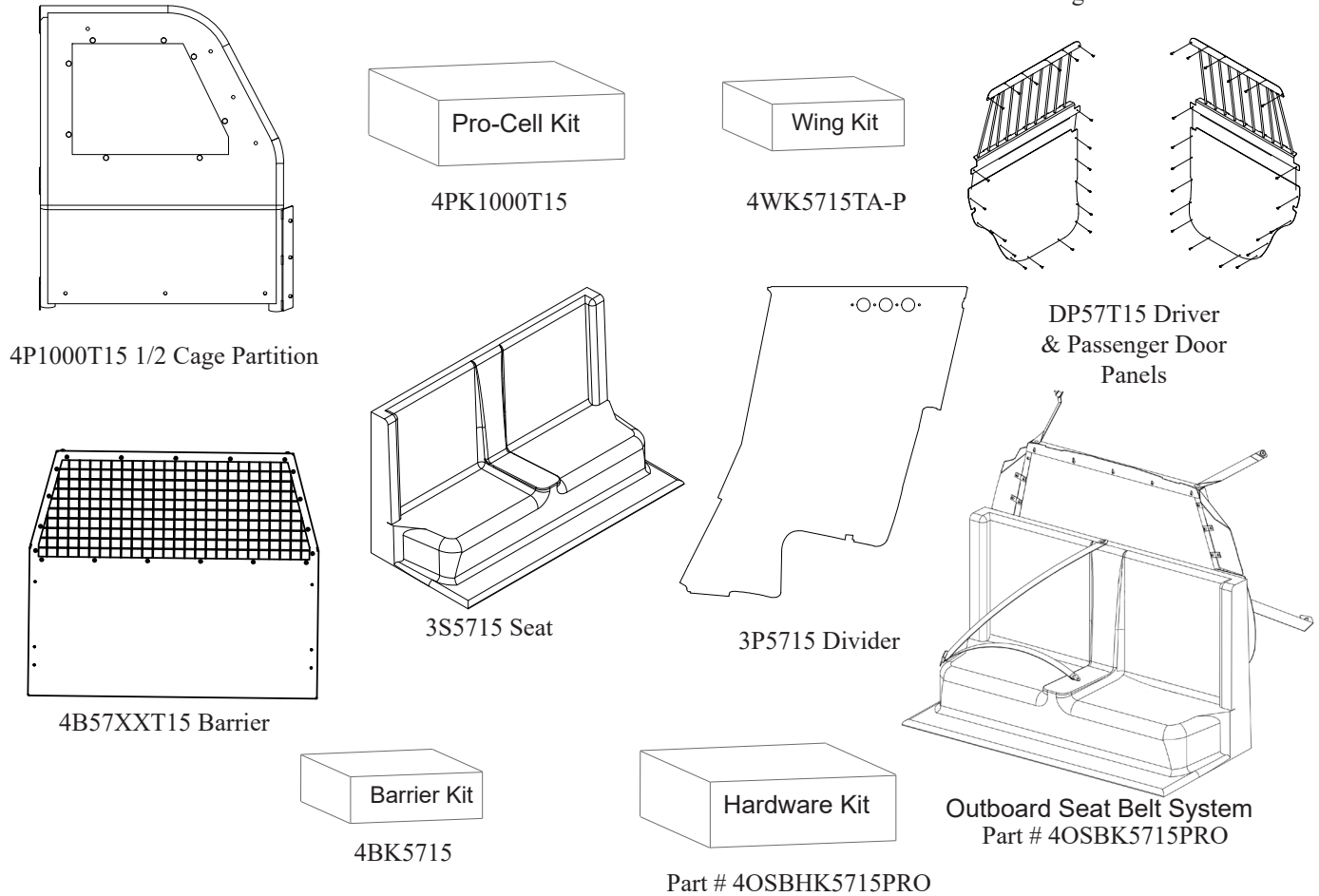

I. The following tools will be required to complete the installation.

- A. 7/16" Socket & Ratchet
- B. 7/16" Open ended Wrench
- C. 3/16" Allen Wrench
- D. 3/8" Socket & Ratchet
- E. 3/16" Drill Bit
- F. 1" Hole Saw & Drill Bit
- G. 5/16" Drill Bit

NOTE: All instructions are located in the individual kit packaging. To locate barrier installation instructions, open the barrier kit package. To locate the seat installation instructions, open the seat kit package. If any instructions are not found, then please visit the www.pro-gard.com website to download a PDF instruction.

II. Read all instructions carefully and refer to page 8 to ensure all parts were received.

WARNING: Locate All wiring, fuel lines, brake lines, coolant lines, or refrigerant lines before drilling any holes or installing any self-drilling fasteners.

NOTE: The standard transport seat can be upgraded with the Outboard Seat Belt System by ordering the 4OSBK5715 kit. Remove the standard seat, upper seat support bar, and seat belt brackets from the vehicle and proceed by following the instructions and complete the OSB installation.

CAUTION: The Tahoe barrier must be installed before proceeding any further using the instructions included with the barrier.

III. Seat Belt Support Bracket & Cross Bar Installation

A. After the barrier has been completely installed, then proceed by attaching the lower (3OSB5715-08) and upper support bars (3OSB5715-01). (As shown in Fig. 1) Use the two 3/8-16 bolts (3X114) and nuts (3X170) to secure the support bars together. Attach the seat belt support bracket to the crossbar. It is not necessary to tighten these bolts until step C are completed.

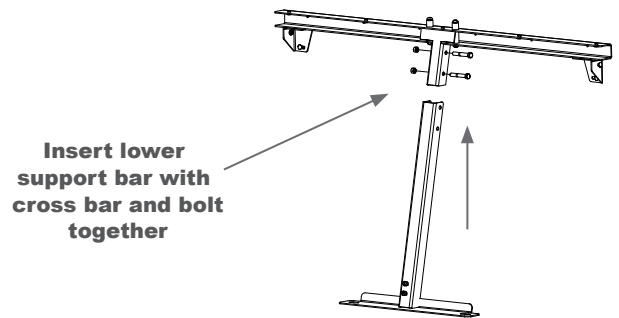

Fig. 1

B. The 2nd row OEM seat should be removed from the vehicle at this time. Find the mounting nuts on the floor board and remove with a 18mm socket. Remove the screws on the barrier that hold the bottom portion of the window. Place the support bar assembly into position inside the vehicle (Fig. 2) and use the supplied (3X06) phillips head screws to hold the outboard seat belt cross bar to the barrier. (Fig. 3) Now attach the driver (3S5715-02) and passenger (3S5715-03) seat belt support brackets to the main seat belt bracket and re-install the two OEM nuts onto the threaded studs to secure the entire assembly.

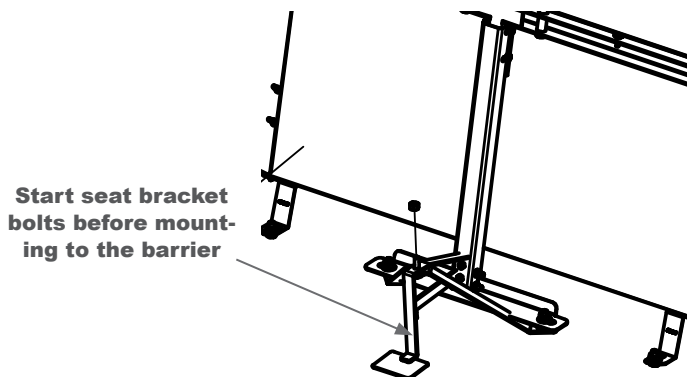

Fig. 2

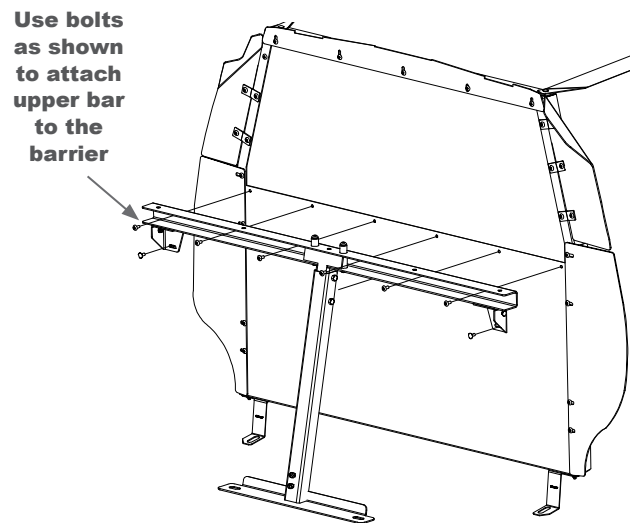

Fig. 3

C. Now the side brackets (3OSB5715-07 D & P) can be attached. Use the provided carriage bolts (3X36) and whiz nut (3X16Z) to secure brackets to the barrier. (Fig. 4) The other end of this bracket uses 10 mm holes in the floor board in the cargo area. The holes are under the floor mat and can be found by rotating the bracket down to the floor and using a sharp object to poke through the floor mat. Tighten all fastener to secure parts in location.

D. The lower seat belt buckle should be installed at this time and before seat installation. Remove the passenger OEM seat belt by using a torx bit driver and feed the belt behind the trim hidden away. The new lower buckle bolt right into this OEM belt location on the passenger side C-pillar using the OEM fasteners as shown in figure 5 and the main BOM diagram.

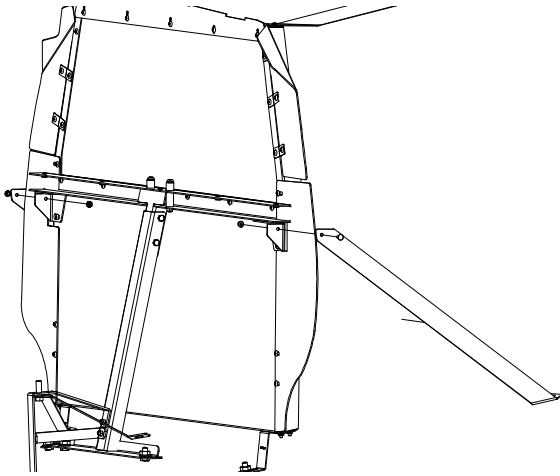
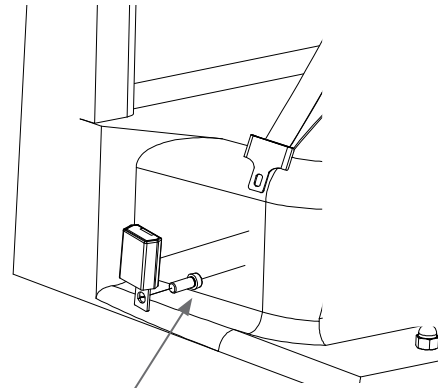

Fig. 4



**T-50 Head
OEM Bolt**

Fig. 5

IV. Seat and Seat Belt Installation.

- A. First, use the provided template on the last page to cutout the seat for the outboard seat belt standoffs and then place the seat loosely inside the vehicle. Place bolts through the seat belt mounting points to see how they line up with the seat. Quickly test the seat belts and do any adjustments needed before bolting in place. Make sure the belt pull straps go down over the chest when installed.

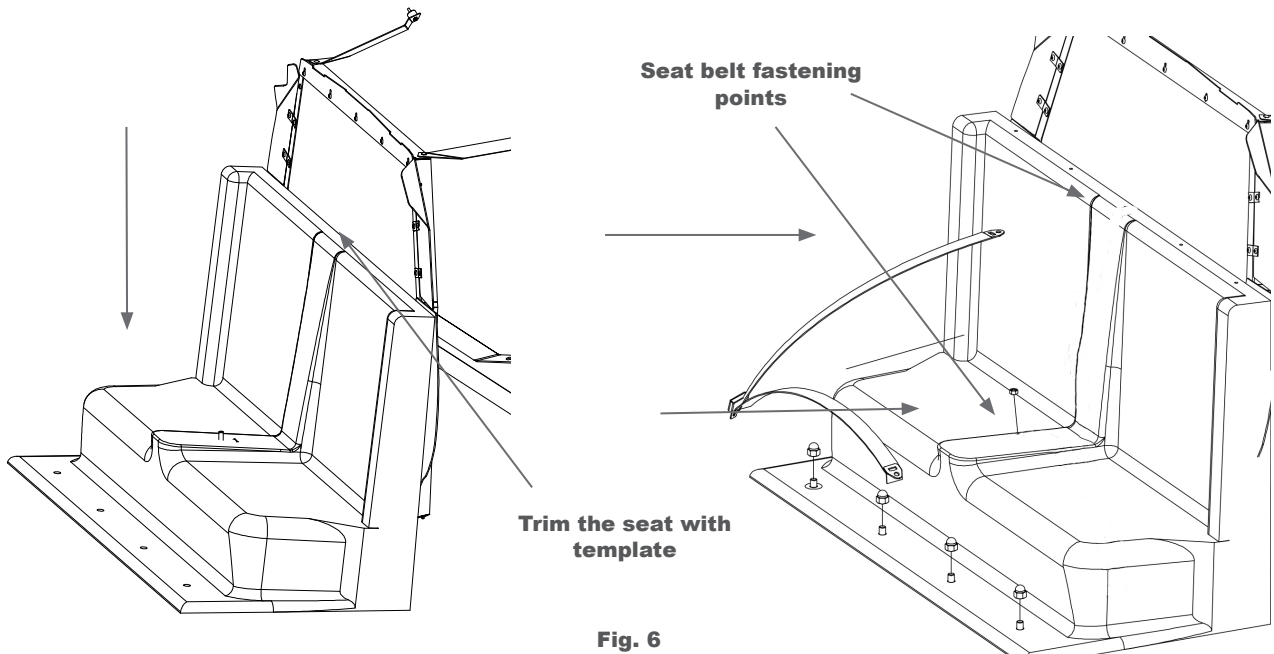

Fig. 6

- B. The seat belts are mounted in two places by the supplied bolts (3X238) and nuts. One mounting point is in the center of the vehicle coming off of the middle of the transport seat. The other is at the top of the cross bar where the standoffs are located. It is only necessary to start the fasteners at this point and move onto fastening the seat in place. (Fig. 6)
- C. Insert the 1/2" plastic spacers (4S5070P1) underneath the seat to allow the acorn nuts to properly tighten. The seat is secured by installing the 5 bolts (3X223) and washers (3X12) at the top of the seat and the 4 acorn nuts (3X183) and washers (3X260) at the floor of the seat.

V. Preparing the B-Pillar.

- A. Locate and remove the lower part of the b-pillar trim to access the sheet metal body. After the trim is removed position the (3PK5715-01P) passenger side b-pillar bracket in location and mark the 4 holes to drill a pilot (with 3/16" drill bit) for the self tapping screws (3X162). The b-pillar bracket is located when the tab is all the way down on the slot as shown in fig. 7. Secure the b-pillar brackets to the passenger sides of the vehicle with the self-tapping screws.

Use tab to place b-pillar bracket in location

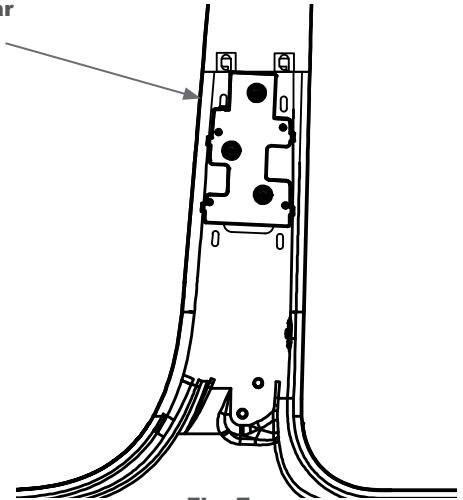

- B. Use the supplied b-pillar template on the last page to mark the three holes in the lower b-pillar trim and drill out the 1" holes so the standoffs can fit through and re-install the trim.

VI. Mounting Brackets.

- A. When b-pillar bracket installation is completed and the trim is re-installed, then the lower sheet metal side panel (3PK5715-02P) can be installed.

- B. Use three (3X149) screws to bolt the passenger side panel into place leaving bolts loose until the partition is installed. (See fig. 8)

- C. Move the driver's seat all the way forward and loosen the driver's seat mounting bolt as shown in fig. 3. (Removal of the passenger side bolt is not necessary!) Push and lift on backside of seat to slide the (3PK5715-10) center support bracket underneath the driver's seat track and reinsert OEM bolt to secure.

Install the lower sheet metal panels to b-pillar brackets

Must use front holes with Pro-Cell unit

Fig. 8

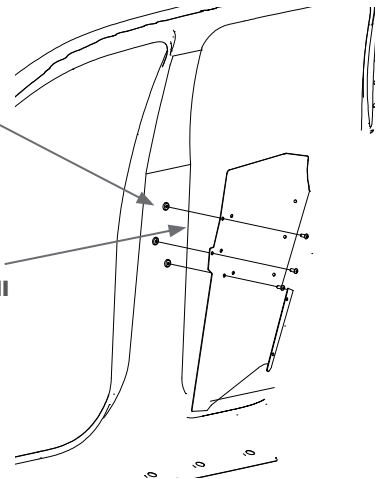

- D. Attach the Pro-Cell mounting bracket to the center support with (3X36) screw and (3X16Z) whiz nuts. (See fig. 9)

Fig. 9

Remove driver's seat bolt & slide bracket underneath track

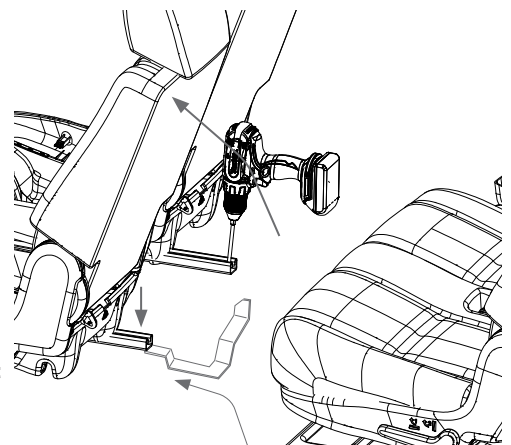

VII. Half Cage Installation (Requires the transport seat be installed before proceeding using the provided instructions packaged with the seat!)

3G620 Upper bracket attaches to barrier as shown

A. At this point, the barrier and seat should be installed! The seat will need (3P214) divider mount brackets bolted as shown in main breakout diagram. Be sure to place the brackets offset so that the divider is in the center of the seat. Refer to seat and barrier kits for complete installation instructions.

B. Attach (3G620) upper divider bracket to the barrier as shown at the top of fig. 10.

B-Pillar sheet metal panel bolts

C. After the seat and barrier are installed, place the (4P1000T15) half cage partition in the vehicle and bolt (3X36) screws and (3X16Z) whiz nuts to b-pillar sheet metal panel on the passenger side and the center mounting bracket behind the console area. Make sure to lift the partition tight to ceiling while securing bolts.

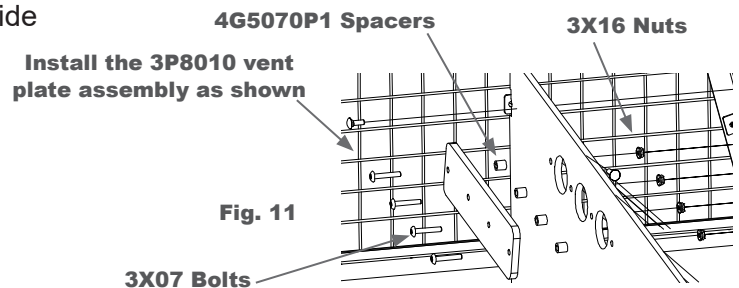
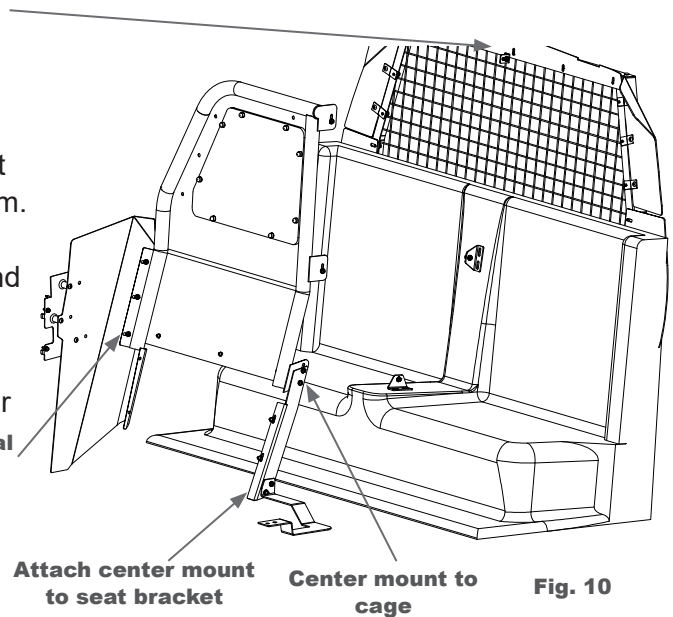

VIII. Divider Installation

A. Attach (3P8010) vent plate to the (3P5715) divider as shown in fig. 11 using the supplied spacers, bolts, and nuts.

B. Insert the (3P5715) divider through the passenger side door and place in position. Examine the alignment of the profile and adjust to fit. Hold the divider securely with no movement occurring while marking hole locations at the bracket mounting points. Drill 5/16" thru holes and insert (3X82) screws and (3X16Z) whiz nuts. Tighten all divider bolts to secure in position.

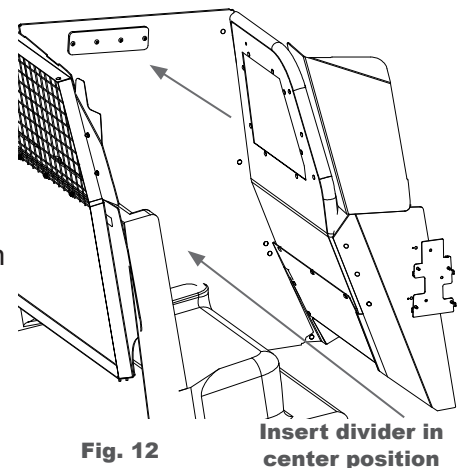

IX. Seat Protector

A. Attach (3SP5715-05) seat protect from the backside of the partition. Align partition and center bracket holes and bolt together with (3X36) and (3X61) screws and (3X16Z) whiz nuts. (See diagram on pg.12)

B. Place (3X145) black plastic caps on all exposed whiz nuts to finish installation.

X. Partition Buckle Installation

- A. Now the partition seat belt buckle bracket should be attached to a convenient place on the driver and passenger side panels allowing the seat belt to be placed in the open position. The open seat belt position allows the user easy access while loading passengers into the back seat belt system. (Fig. 13)

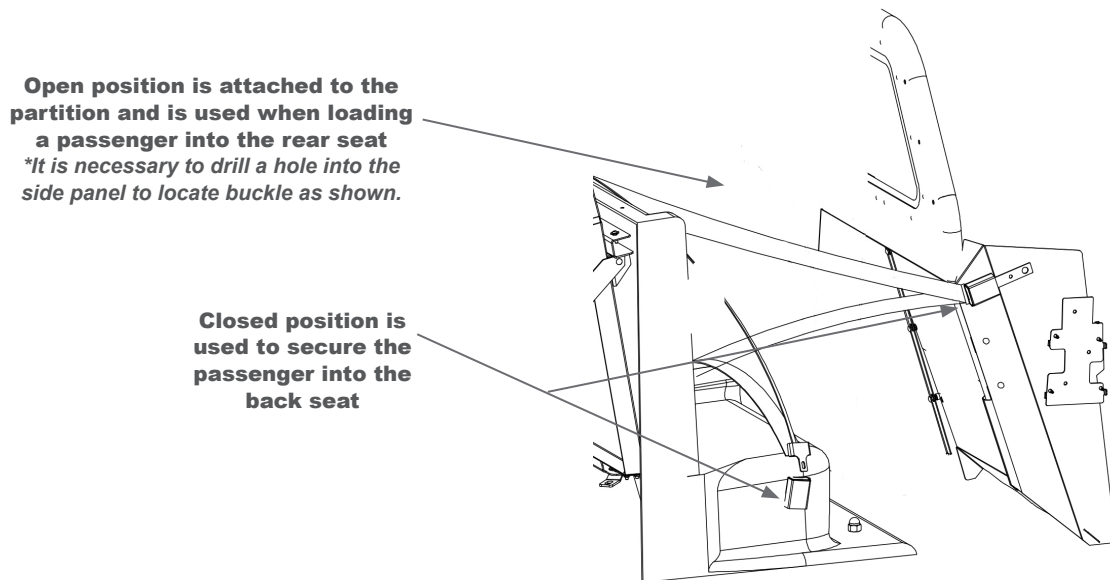

Installation complete!

If you have any problems with this installation then call the toll free number (800-480-6680) and ask for technical assistance.

FABRICATED PARTS LIST		
ITEM	QTY	PART NUMBER
1	1	3PK5715-10
2	1	3PK5715-01P
3	1	3PK5715-05
4	1	3PK5715-02P
5	2	3PK5715
6	1	3PK5715-11
7	1	3PK8010
8	1	40S85715-15
9	1	30S8109RP-1
10	1	30S8-01
11	1	30S85715-01
12	1	30S85715-07D
13	1	30S85715-07P
14	1	30S85715-08
15	1	30S85715-10
16	1	35S715-02
17	1	35S715-03
18	1	30S8001
19	2	40S85715-16
54	1	30S85715-14

HARDWARE LIST		
ITEM	QTY	PART NUMBER
20	2	3P214
21	1	3G620
22	3	3X149
23	4	3X162
24	8	3X36
25	21	3X162
26	1	3X61
27	10	3X82
28	4	3X16
29	4	3X07
30	4	4G5070P1
31	22	3X145
32	2	3X170
33	2	3X56
34	4	3X183
35	4	3X114
36	1	3X182
37	5	3X12
38	5	3X223
39	4	3X260
40	4	455070P1
41	6	3X06
42	2	3X245
43	2	3X239
44	2	3X222
45	2	3X224
46	8	3X72

ADDITIONAL REQUIRED PARTS		
ITEM	QTY	PART NUMBER
47	1	35S715
48	1	4B5702115
49	1	4B5715
50	1	45S7115
51	1	WBXXS57115
52	1	DP5715
53	1	4W5715A-P

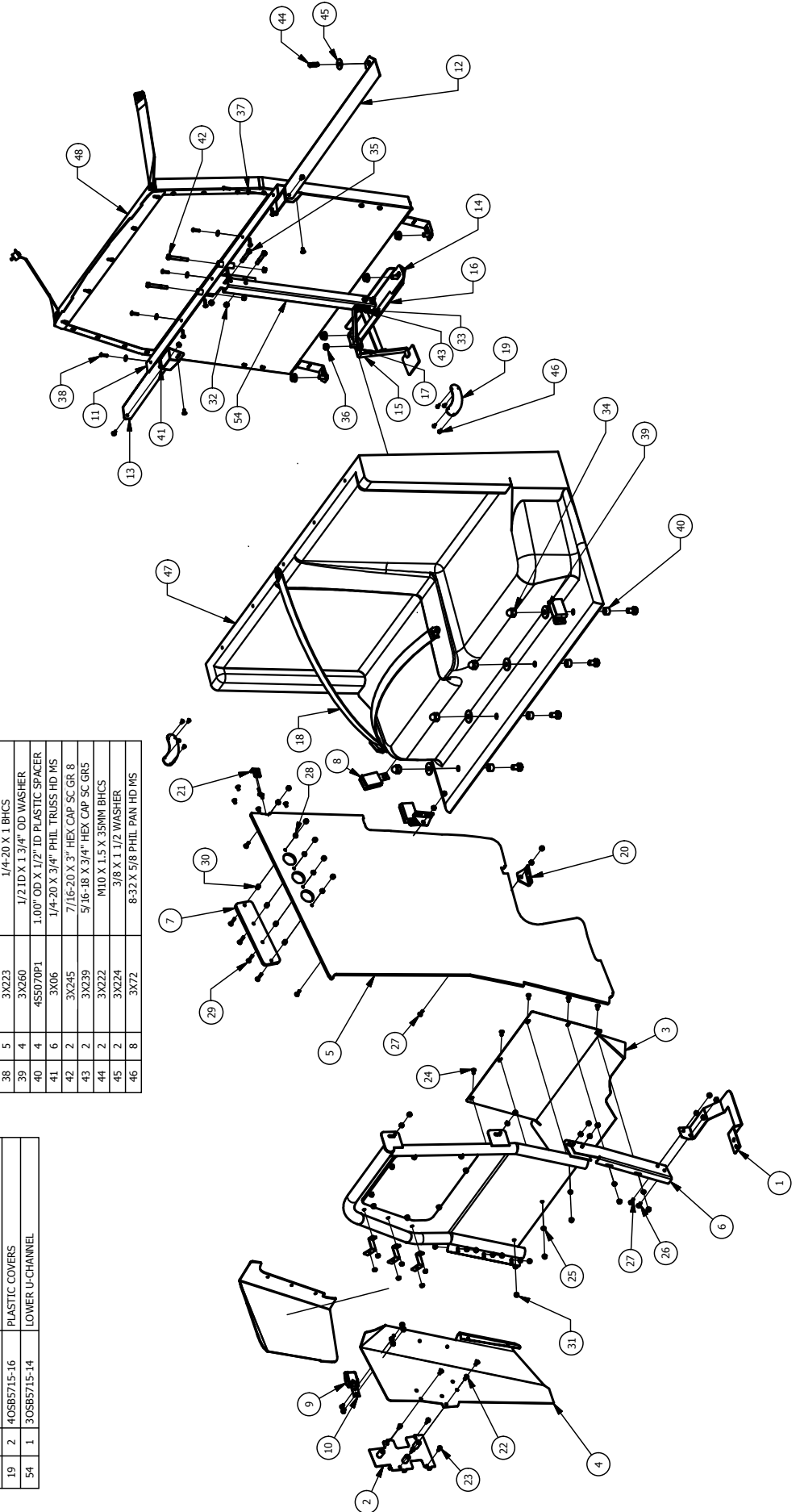

2015 Tahoe Outboard Seat Belt Template

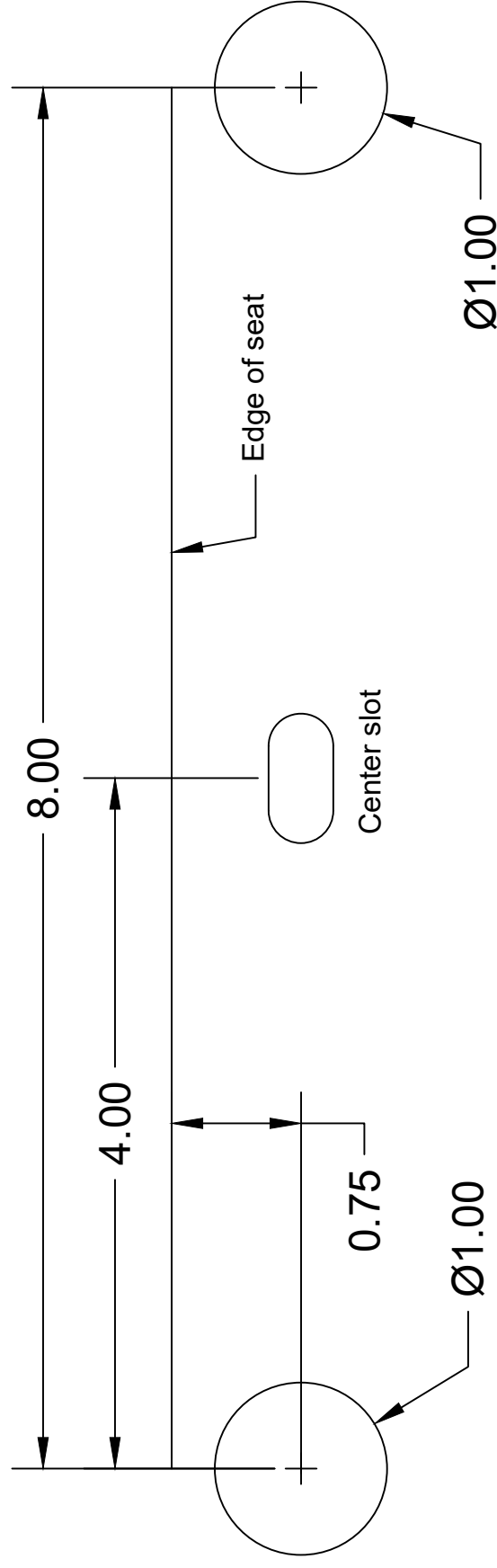

1. Locate the center slot at the top of the transport seat and align with template.
2. Mark the center points of the two 1.00" dia. holes as shown.
3. Use a 1.00" hole saw to make holes into the plastic seat for the seat belt standoffs.

DIRECTIONS

1. CUT ALONG THE DASHED LINES
2. REMOVE THE B-PILLAR TRIM AND PLACE TEMPLATE INSIDE ALIGNING CUT OUT AREAS WITH THEIR CORRESPONDING FEATURES ON THE OEM TRIM PANEL
3. CENTER PUNCH 3 HOLE LOCATIONS THRU TEMPLATE & DRILL/CUT 1" DIA. HOLE
4. REINSTALL TRIM PANELS OVER TOP OF THE B-PILLAR BRACKETS

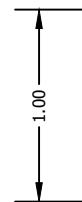
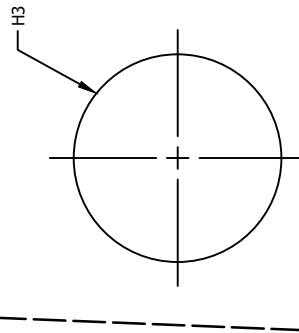
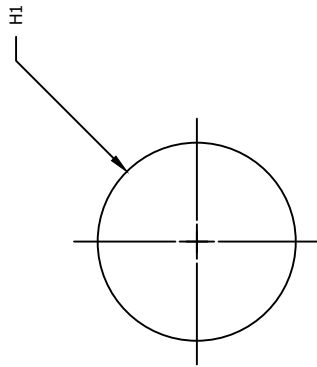

CHECK SCALE
SELECT NONE FOR PAGE SCALING
WHEN PRINTING FROM .pdf FILE

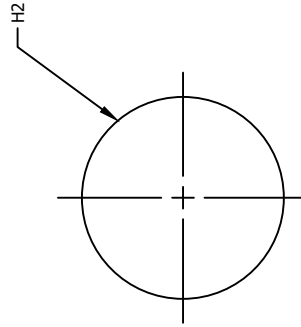
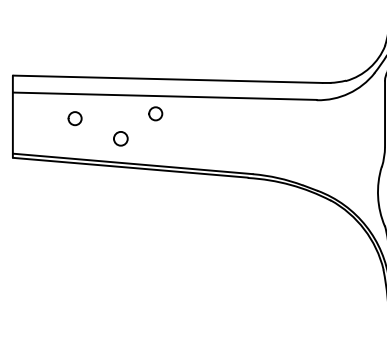

2015-CURRENT
CHEVROLET TAHOE PPV
B-PILLAR TRIM TEMPLATE PASSENGER