

INSTALLATION GUIDE

BDP57L3TAH15
BALLISTIC DOOR PANEL
2015-2020 CHEVROLET TAHOE

Pro-gardTM
PRODUCTS LLC.

STRONG. RELIABLE. SECURE.

pro-gard.com
800.480.6680

Components List (Drivers Side Panel Install)

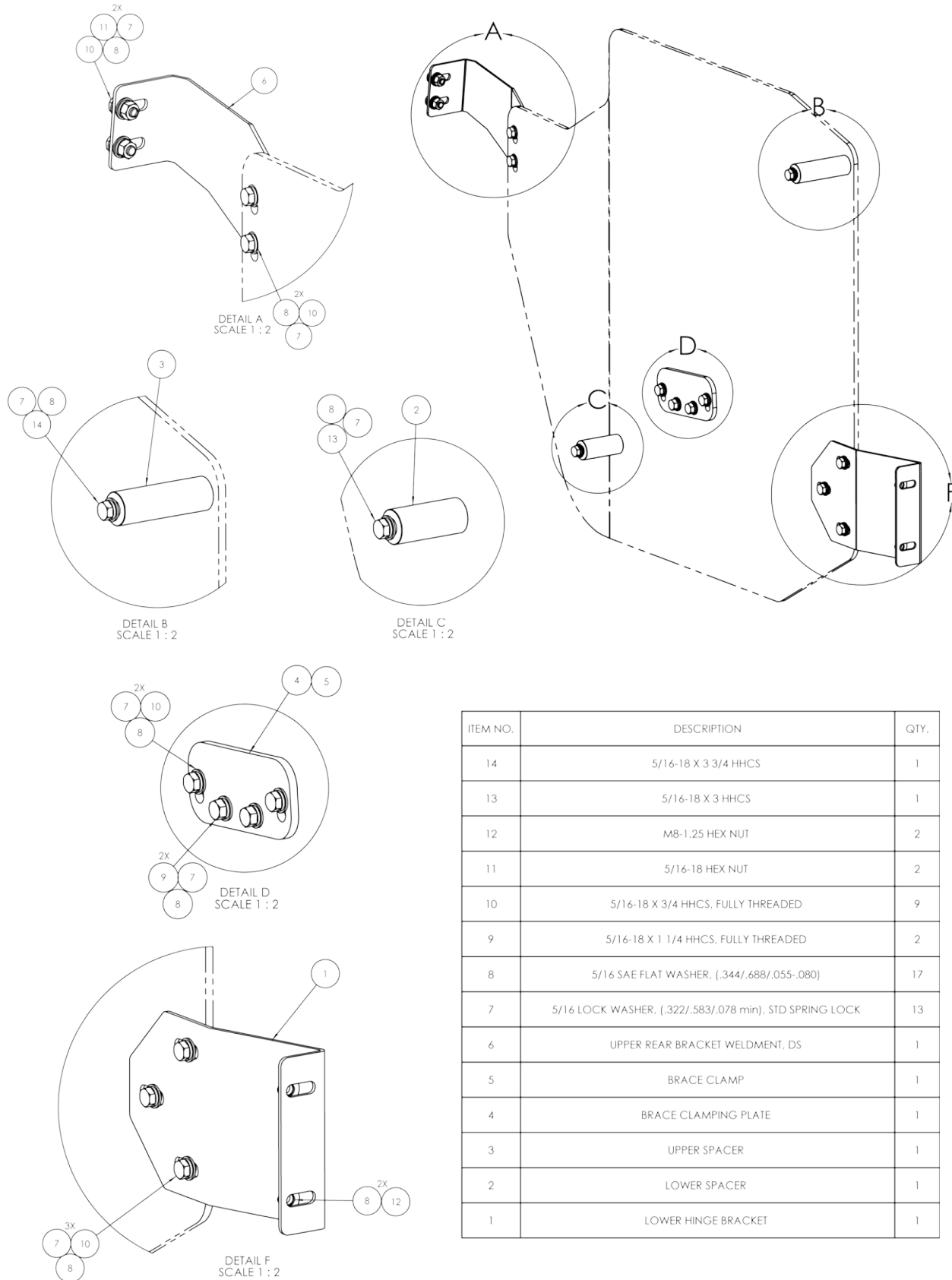

Installation Instructions

1. Remove the inner door plastic panel and padding to prepare for the BDP Install by completing the following steps:

- a. Remove the door panel bolts and pull the plastic panel away careful of the plastic clips.
- b. Remove the interior handle brace.
- c. Remove the interior seal cover.
- d. Disconnect the speaker and door and window motor control panel connectors from the plastic door panel.
- e. Remove the speaker.
- f. Remove the rubber seal from window track.
- g. Remove the interior and exterior window trim.
- h. Disconnect and remove the mirror.
- i. Loosen the two window track clamps and remove the glass while in fully down position.
- j. Remove and discard the foam block by sliding a putty knife along the double sided tape.
- k. Remove the window motor/guide tracks and the window track below the door handle.



2. Prepare the door for the panel by completing the following:

- a. Prepare the noise dampening tape by cutting it in half with scissors.
- b. Place one piece of tape onto the upper brace, located on the inside of the door.
- c. Place the remaining piece of tape onto the lower brace.



3. Slide the panel in front first; rotating clockwise, making sure it is behind the front window track:

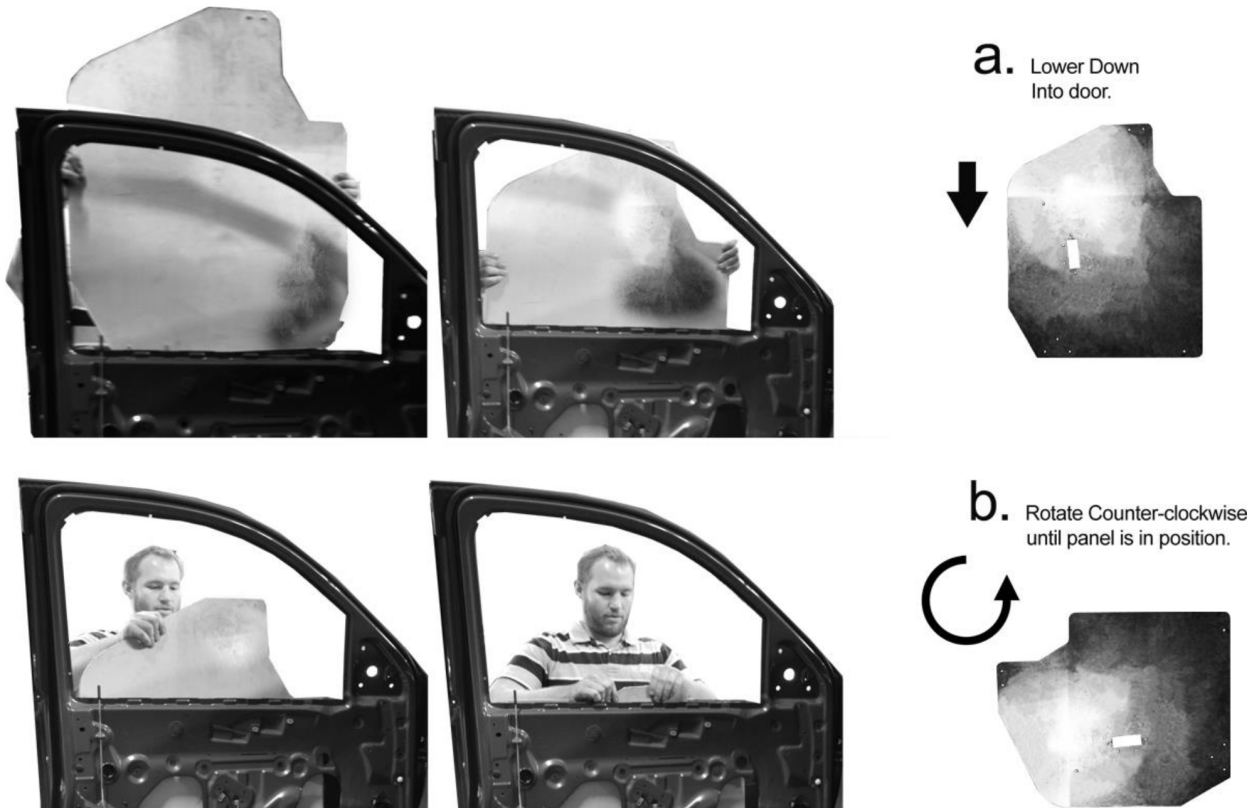

4. Roughly center the panel by temporarily inserting a block of scrap wood or metal into the center bracket hole to align it with the door center brace.

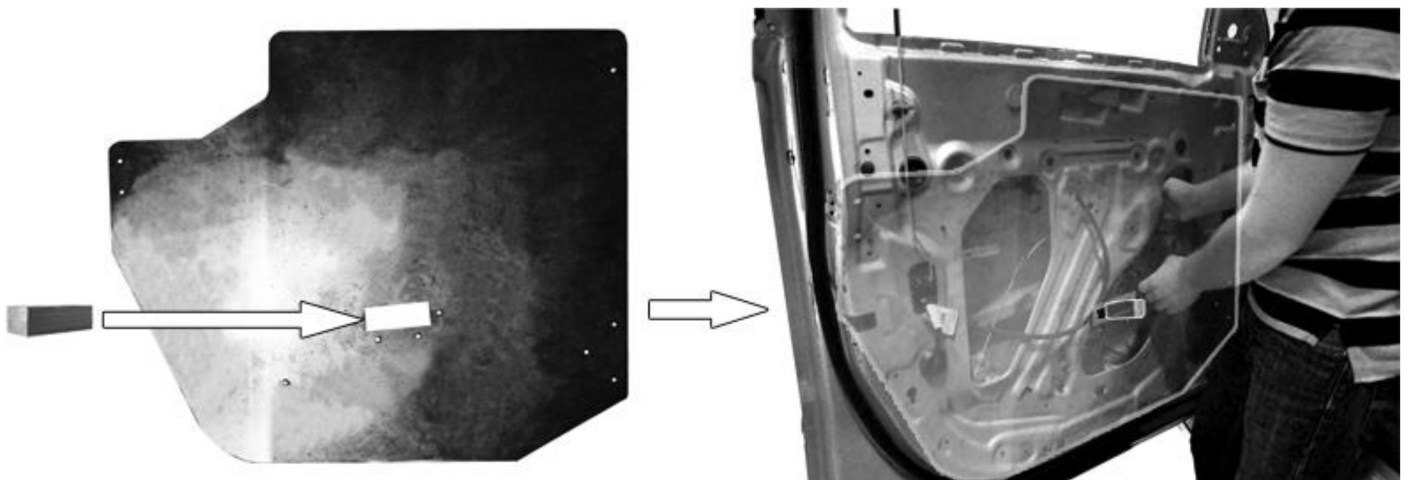

5. Attach the lower hinge bracket to the lower door by loosely installing two M8-1.25 Hex Nuts and 5/16 SAE Flat Washers onto the existing door hinge bolts:

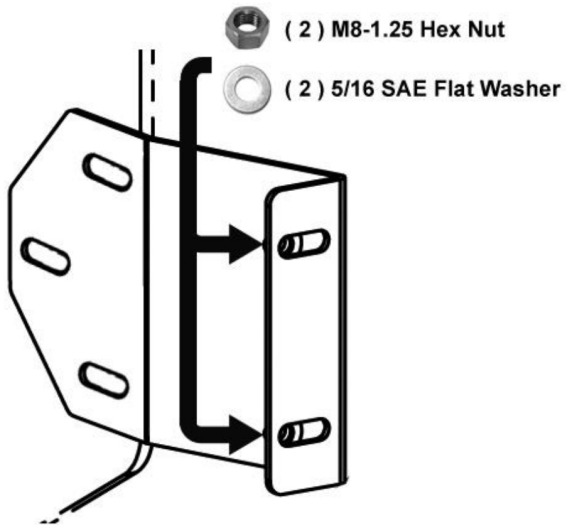

6. Attach the Lower Hinge Bracket to line up with the panel mounting holes by loosely installing three each of 5/16-18 x 3/4 HHCS, 5/16 SAE Flat Washer, and 5/16 Lock Washer:

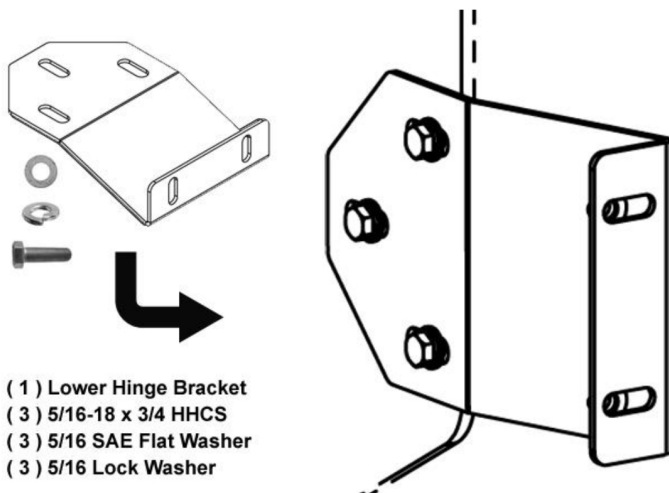

7. Prepare the Upper Rear Bracket install by first drilling the two holes as shown in the attached Door Jam Drilling Template (please see last page of install guide for template):

- a.) Cut out the Door Jam Template.
- b.) Line up the Door Jam Template to the Door Jam.
- c.) Tape the Template to the Door Jam.
- d.) Use a marker to mark the drill holes on the Door Jam.
- e.) Drill out the two 3/8" Upper Rear Bracket install holes.

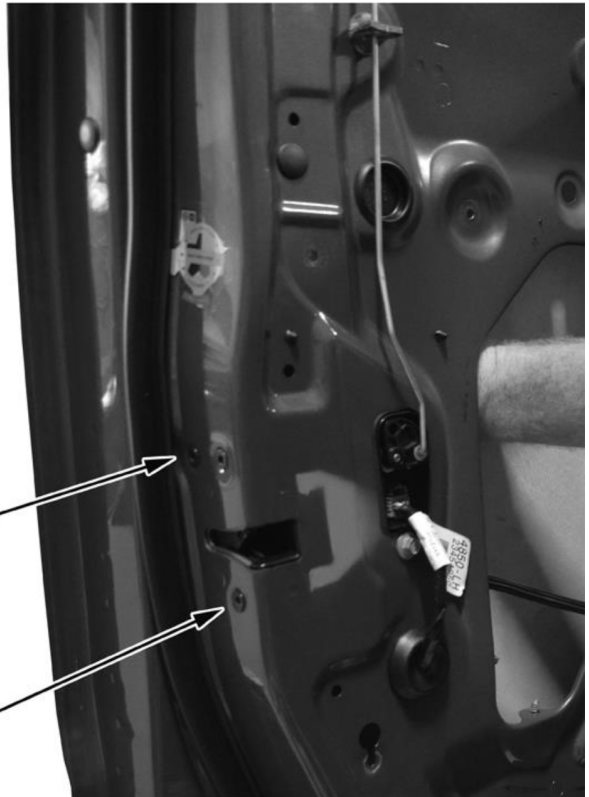
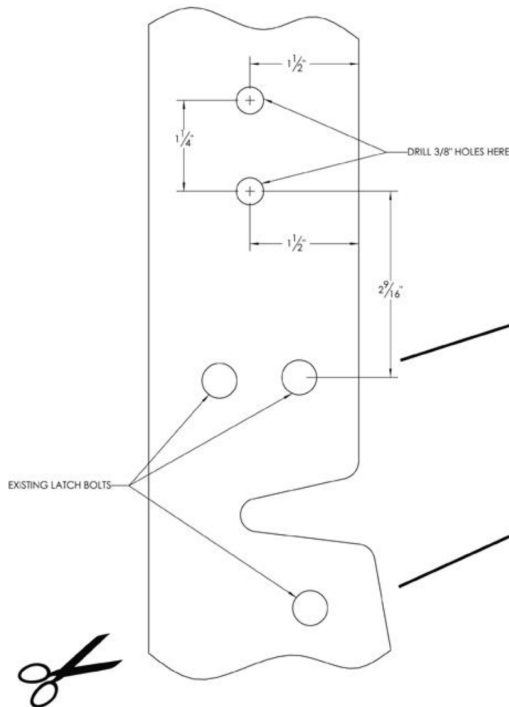

8. Once the holes have been drilled, loosely attach the Upper Rear Bracket to the panel using 2 each of the 5/16-18 x 3/4 HHCS, 5/16 SAE Flat Washer, and 5/16 Lock Washer:

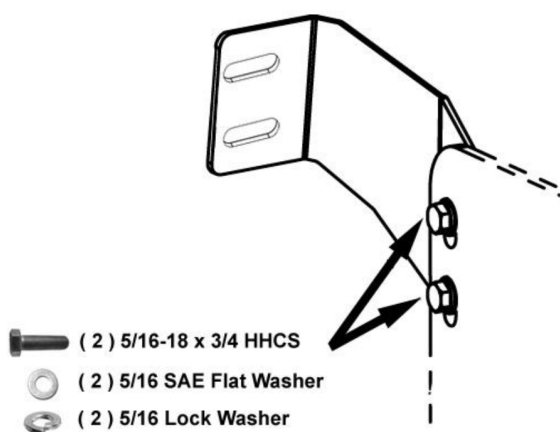

9. Loosely install the upper hinge bracket to the door using 2 each of the 5/16-18 Hex Nut, 5/16-18 x ¾ HHCS Bolt, 5/16 SAE Flat Washer, and 5/16 Lock Washer:

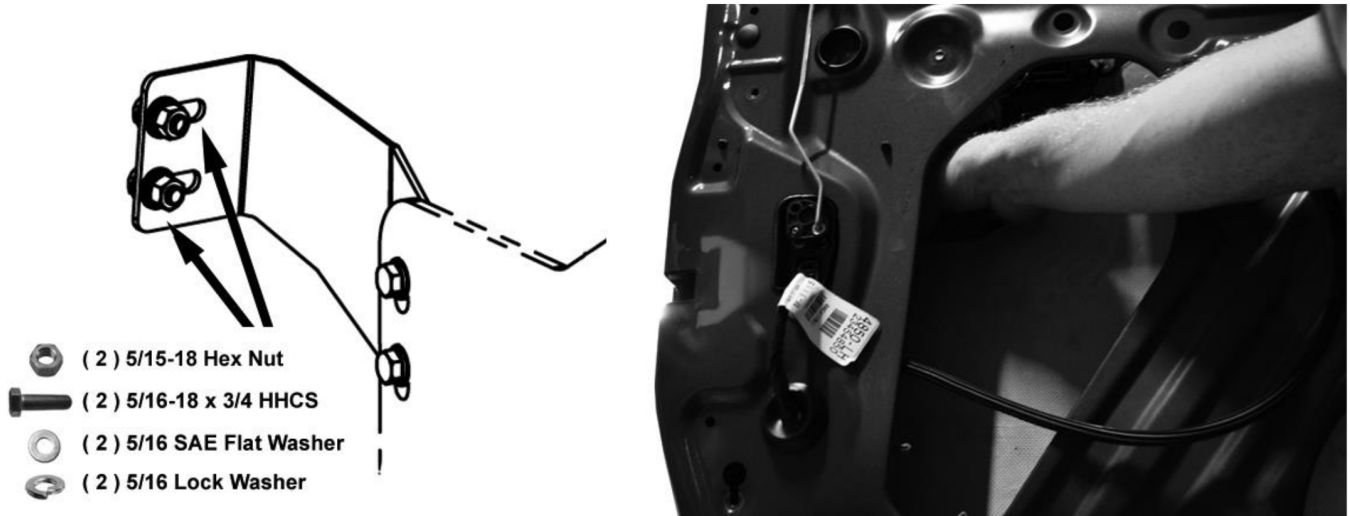

10. Install the center Brace Clamp and the Brace Clamping Plate by completing the following steps:

- Align the screw holes on both the Brace Clamp and the Brace Clamping Plate.
- Loosely attach the sides of Brace Clamping Plate to the Brace Clamp using 2 each of the 5/16-18 x ¾ HHCS, 5/16 Lock Washer, and 5/16 SAE Flat Washer.
- Loosely connect the Brace Clamping Plate to the Brace Clamp along the bottom using 2 each of the 5/16-18 x 1 ¼ HHCS, 5/16 Lock Washer, and 5/16 SAE Flat Washer.
- Remove the block of wood/metal used to temporarily align the panel.
- Slide the Brace Clamp assembly through the center brace hole.
- Press down on the top of the inserted Brace Clamp assembly to ensure that it is fully down towards the bottom of the door to ensure that it is clamping the door brace properly.
- Fully tighten the 4 Brace Clamp assembly bolts.

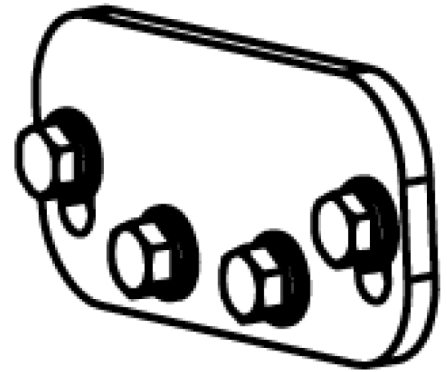

11. Prepare for the install of the Upper and Lower Spacers by marking and then drilling the two Spacer holes by completing the following steps:

- a. Place the Upper Spacer in the panel mounting hole.
- b. Place the Lower Threaded Spacer behind the lower door.
- c. Mark the drill holes in the I
- d. Use a 3/8" drill bit to drill both the upper and lower spacer holes.

INSTALLATION COMPLETE

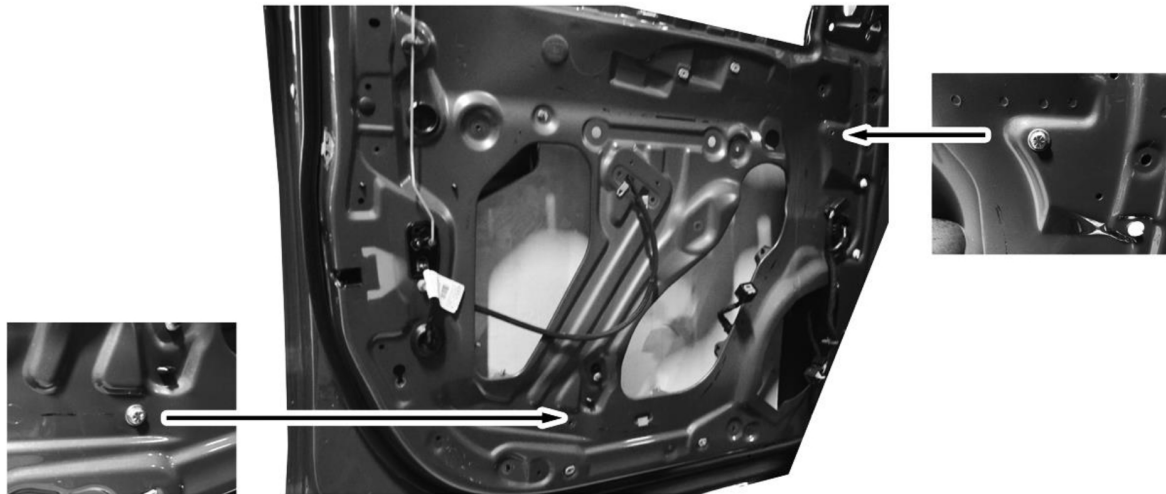
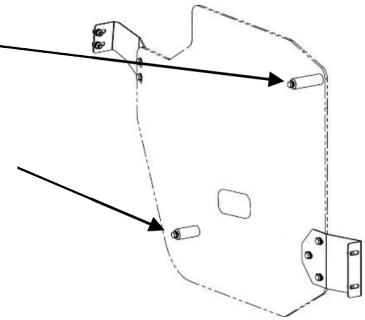

12. Attach the Upper Spacer to the upper Weld Nut and hole drilled in step 11 by loosely installing 1 each of the following hardware:

- 5/16-18 x 3 3/4 HHCS
- 5/16 Lock Washer
- 5/16 SAE Flat Washer

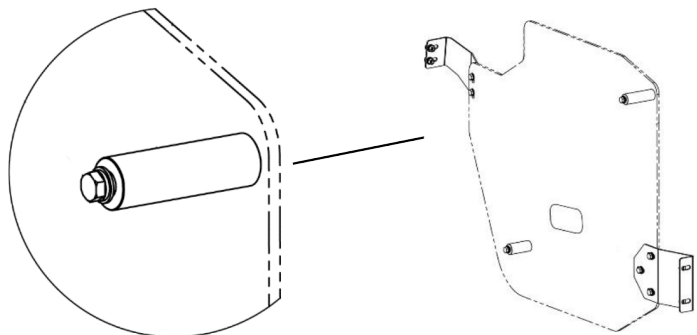

13. Attach the Lower Spacer to the lower hole drilled in step 11 by installing 1 each of the following hardware (Tighten Completely):

- ¼-20 x 3" HHCS
- 5/16 Lock Washer
- 5/16 SAE Flat Washer

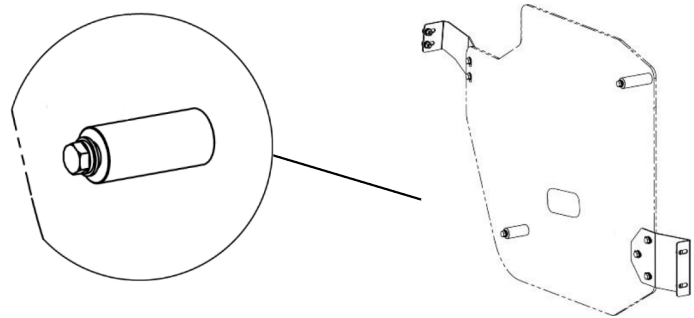

14. Tighten all bolts and adjust panel to make sure nothing is in the way of the window track by ensuring that the panel is pressed tightly against the out facing side of the door.

15. Reassemble the door window track, seals, mirror, speaker, handle brace, and plastic door panel to complete the Tahoe NIJ Level III Ballistic Door Panel installation.

INSTALLTION COMPLETE

