

PB57T07
INSTALLATION INSTRUCTIONS
2007 TAHOE
PUSH BUMPER



- **BE SURE TO CAREFULLY REVIEW ALL INSTRUCTIONS BEFORE INSTALLATION.**
- **BEFORE DRILLING HOLES OR INSTALLING FASTENERS INTO THE VEHICLE, BE SURE TO LOCATE ALL BRAKE, OIL AND FUEL LINES, ELECTRICAL WIRING AND ANY OTHER COMPONENTS THAT MAY BE DAMAGED AS A RESULT.**
- **THIS PUSH BUMPER IS DESIGNED FOR THE ½ TON 2007 TAHOE POLICE EDITION ONLY.**

NOTE: Carefully review the parts list below. If there are any missing parts, please call (317)-579-6680 and ask for “Customer Service” or circle the missing part on this sheet and fax to (317) 579-6681.

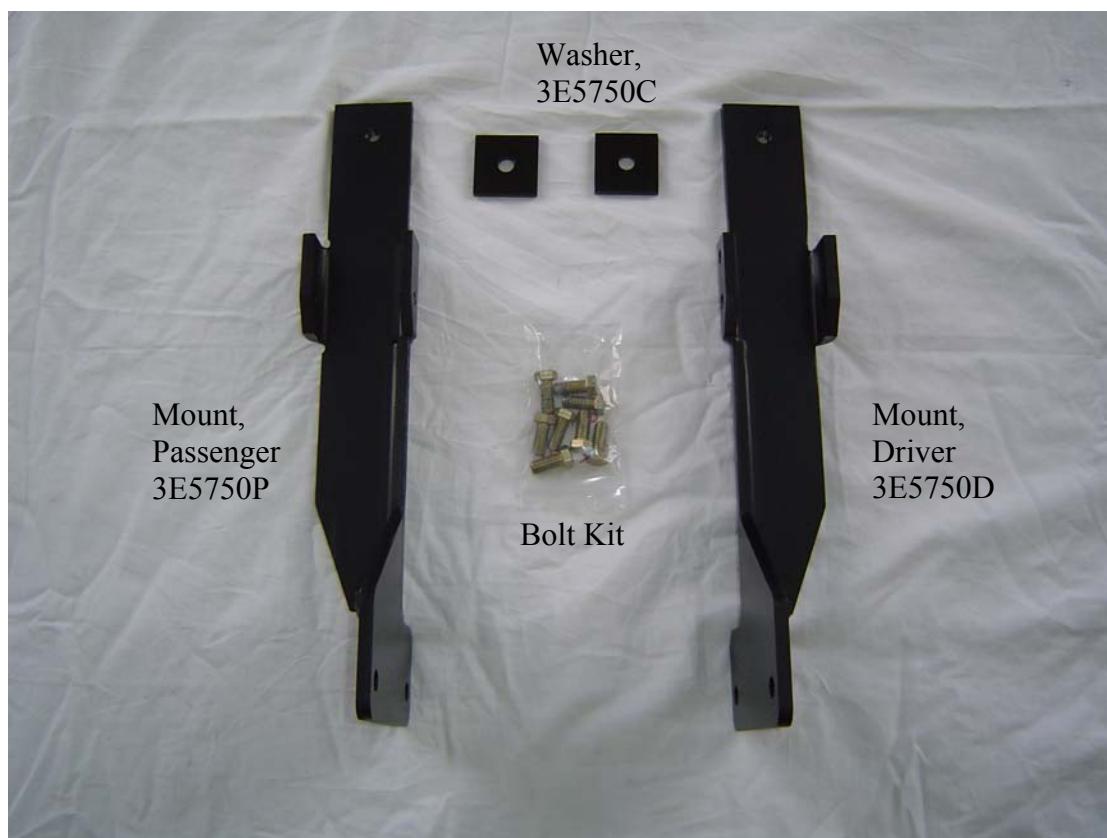
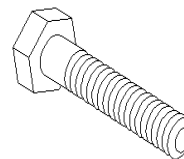

Figure 1

Suggested tools:

5/8" Socket/wrench
5/8" End Wrench

15 MM Socket/wrench
15 MM End Wrench



3X146
7/16-14 X 1 HEX BOLT (YZD)
(8 REQ'D)

I. Removing the OEM tow hooks and trim insert

- A. Begin by removing the 2 bolts and 1 nut from each side of the front sub-frame box beams that secure the tow hooks. Remove the tow hooks through the front bumper cover.
- B. Now the plastic trim inserts around the tow hook access holes in the bumper cover can be removed. Disengage the locking barbs and slide trim to the rear.

II. Installing the push bumper mounting brackets

- A. Insert each Push Bumper Mount through the bumper cover and inside the end of the front sub-frame box beams. The flanges with the tapped holes face up. Note that the mounting pattern is the same on each mount of the truck making it is possible to install the brackets on the wrong side. The flat faces of the vertical flange should face each other and gussets should be to the outside. **See fig. 2**

Figure 2



- B. Locate the 1-1/4" hole in the bottom of the sub-frame about 7" back from the front. Slide the Push Bumper Mount back until the tapped hole becomes visible through the large hole. Start a bolt and HD washer through this hole into the tapped hole in the mount. Start the other 3 bolts. Repeat on other side of truck. Leave all bolts loose until all fasteners are installed. This will aid in alignment to the Front Section Assembly. **See fig. 3**

- C. Assemble #E1106 Push Bumper Front Section (packaged separately) per instructions. Note: This application is a “direct mount” and does not require the large angle mounting brackets shipped with the Front Section.
- D. Once assembled, place it around the outside of the two mounting brackets and attach with four black ½” bolts, nuts and lock washers supplied with the Front Section. See fig. 4



Figure 3



Figure 4

- E. Tighten all fasteners. Installation is complete.

IF YOU HAVE ANY QUESTIONS OR CONCERNS PLEASE CONTACT

Pro-gard Products, LLC
PHONE: 317-579-6680